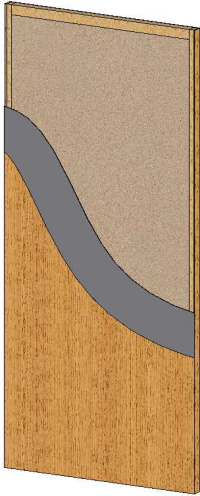

**Lynden Door
Commercial Series**
**CD900
Mineral Core**
90 min. Rated

FACES: HPVA Architectural "A" grade wood veneer (minimum thickness 1/50" before sanding)
Options: "AA" grade wood veneer, paint grade MDO
 Hardboard

SUBSTRATE: Engineered wood composites

CORE: Fire rated mineral

STILES: Fire rated composite with outer band of mill option AWS Type A wood
Option: (CE) Compatible with face veneer, AWS Type B Wood Veneer

RAILS: Mill option fire rated composite material.

ASSEMBLY: Bonded assembly in compliance with fire door listings.

ADHESIVES: Type 1

MAXIMUM SIZE: POSITIVE PRESSURE WITH HOSE STREAM
 4'0" x 9'0" (1220mm x 2743mm)

NEUTRAL PRESSURE WITH HOSE STREAM
 4'0 x 10'0 (1220mm x 3050mm)

THICKNESS: 1 3/4" (45 mm)

Option: Up to 2 1/2" (63.5 mm)

WARRANTY: 5 years, for interior use only. See warranty terms and conditions

STANDARDS: Performance attributes meet or exceed WDMA IS-1A and AWS Extra Heavy Duty Standards when specified with blocking for surface applied hardware without through bolts.
Option: WDMA IS-1A and AWS Custom Grade

FIRE RATING: Positive Pressure Category B or Neutral Pressure **Option:** Positive Pressure Category A
 Positive Pressure tested in accordance with UBC 7-2 1997, UL-10C and NFP 252
 Neutral Pressure with hose stream tested in accordance with UBC-7 1994 and UL-10B
 For additional information on fire doors please refer to the Lynden Door Fire Door Technical Sheets.

ACOUSTICAL RATING Information presently not available.

ENVIRONMENTAL Attributes: Recycled content, regionally manufactured, may apply – see **GREENDOR™** Contribution Sheets.

Manufacturing Options

BLOCKING: Special blocking options may be specified. (Reference WDMA I.S.1A blocking options HB-1 through HB-8)

MACHINING: Machining for hardware, open cutouts, installation of lites and louvers, sketch faces, applied moldings, plant ons, raceways, concealed vertical rods - Hardware cutouts shall be factory machined from manufacturers' templates and shop drawings.

TRANSPARENT FINISH WDMA TR6 / AWS System 9 -UV cured catalyzed polyurethane finishes in standard and custom match stains
Options: Other finish systems available

OPAQUE FINISH: Factory painting in standard and custom match colors **Options:** Standard or color tinted priming available