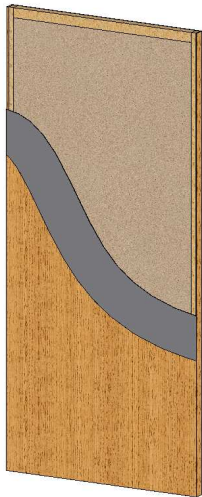

**Lynden Door
Interior Construction Series**
**IC200 PC
Wood Particleboard Core**
Non Rated or 20 min.

FACES:	Limited wood veneers	
SUBSTRATE:	Engineered wood composites or wood veneer plywood	
CORE:	Particleboard ANSI A208.1 LD1	Option: LD2
STILES:	Softwood AWS Type A Solid Wood	
	Option: (CE) Compatible or (ME) Matching with face veneer see IC2000	
RAILS:	Mill option structural composite lumber, wood or composite material.	
ASSEMBLY:	Stiles and rails are securely bonded to the core and the assembled unit is sanded prior to application of faces.	
ADHESIVES:	Type 1	
MAXIMUM SIZE:	4'0" x 8'0" (1219mm x 2438mm)	
THICKNESS:	20 min rated	1 3/8" (45 mm)
	Non-rated	1 3/8" (35 mm) or 1 3/4" (45 mm)

WARRANTY:	Five (5) years for interior use only. See warranty terms and conditions	
STANDARDS:	Performance attributes meet or exceed WDMA IS-1A and AWS Extra Heavy Duty standards when specified with blocking for surface applied hardware without through bolts	
FIRE RATING:	Positive Pressure Category B or Neutral Pressure Positive Pressure tested in accordance with UBC 7-2 1997, UL-10C and NFPA 252 Neutral Pressure with hose stream tested in accordance with UBC-7 1994 and UL-10B For additional information on fire doors please refer to the Lynden Door Fire Door Technical Sheets.	Option: Positive Pressure Category A
ACOUSTICAL RATING	STC 32 ASTM E90-09 – Non operable	OITC 30 - ASTM E90-09 – Non operable
ENVIRONMENTAL Attributes:	Recycled content, regionally recovered and manufactured, may apply – see GREENDOR™ Contribution Sheets.	

Manufacturing Options

BLOCKING:	Special blocking options may be specified. (Reference WDMA I.S.1A blocking options HB-1 through HB-8)	
MACHINING:	Machining for hardware, open cutouts, installation of lites and louvers, applied moldings, plant ons, raceways, concealed vertical rods, decorative routing, dutch doors, doors and transoms - Hardware cutouts shall be factory machined from manufacturers' templates and shop drawings.	
TRANSPARENT FINISH	WDMA TR6 / AWS System 9 -UV cured catalyzed polyurethane finishes in standard and custom match stains	Options: Other finish systems available
OPAQUE FINISH:	Factory painting in standard and custom match colors	Options: Standard or color tinted priming available