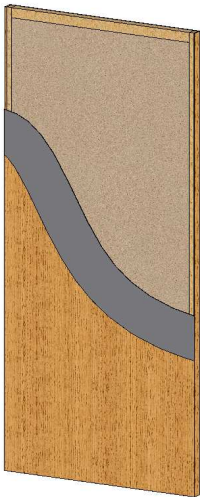

**Lynden Door
Interior Construction Series**
**IC2000 PC
Wood Particleboard Core**
Non Rated or 20 min.

FACES:	Limited wood veneers
SUBSTRATE:	Engineered wood composites or wood veneer plywood
CORE:	Particleboard ANSI A208.1 LD1 Option: LD2
STILES:	(CE) Compatible with face veneer, mill option AWS Type A wood or Type B veneered Option: (ME) Matching with face veneer
RAILS:	Mill option structural composite lumber, wood or composite material.
ASSEMBLY:	Stiles and rails are securely bonded to the core and the assembled unit is sanded prior to application of faces.
ADHESIVES:	Type 1
MAXIMUM SIZE:	4'0" x 8'0" (1219mm x 2438mm)
THICKNESS:	20 min rated 1 3/4" (45 mm) Non-rated 1 3/8" (35 mm) or 1 3/4" (45 mm)

WARRANTY:	Five (5) years for interior use only. See warranty terms and conditions
STANDARDS:	Performance attributes meet or exceed WDMA IS-1A and AWS Extra Heavy Duty standards when specified with blocking for surface applied hardware without through bolts
FIRE RATING:	Positive Pressure Category B or Neutral Pressure Option: Positive Pressure Category A Positive Pressure tested in accordance with UBC 7-2 1997, UL-10C and NFPA 252 Neutral Pressure with hose stream tested in accordance with UBC-7 1994 and UL-10B For additional information on fire doors please refer to the Lynden Door Fire Door Technical Sheets.
ACOUSTICAL RATING	STC 32 ASTM E90-09 – Non operable Option: OITC 30 - ASTM E90-09 – Non operable
ENVIRONMENTAL Attributes:	Recycled content, regionally recovered and manufactured, may apply – see GREENDOR™ Contribution Sheets.

Manufacturing Options

BLOCKING:	Special blocking options may be specified. (Reference WDMA I.S.1A blocking options HB-1 through HB-8)
MACHINING:	Machining for hardware, open cutouts, installation of lites and louvers, applied moldings, plant ons, raceways, concealed vertical rods, decorative routing, dutch doors, doors and transoms - Hardware cutouts shall be factory machined from manufacturers' templates and shop drawings.
TRANSPARENT FINISH	WDMA TR6 / AWS System 9 -UV cured catalyzed polyurethane finishes in standard and custom match stains Options: Other finish systems available
OPAQUE FINISH:	Factory painting in standard and custom match colors Options: Standard or color tinted priming available