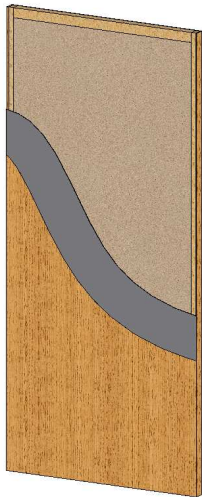

**Lynden Door
Architectural Series**
**IC9000 FD-90
Mineral Core**
90 min. Rated

FACES:	Limited wood veneers	
SUBSTRATE:	Engineered wood composites	
CORE:	Fire rated mineral	
STILES:	(CE) Compatible with face veneer, fire rated composite with outer band of mill option AWS Type A wood or Type B veneered Option: (ME) Matching with face veneer	
RAILS:	Mill option fire rated composite material.	
ASSEMBLY:	Bonded assembly in compliance with fire door listings.	
ADHESIVES:	Type 1	
MAXIMUM SIZE:	POSITIVE PRESSURE WITH HOSE STREAM 4'0" x 8'0" (1219mm x 2438mm)	NEUTRAL PRESSURE WITH HOSE STREAM 4'0" x 8'0" (1219mm x 2438mm)
THICKNESS:	1 3/4" (45 mm)	

WARRANTY:	Five (5) years for interior use only. See warranty terms and conditions	
STANDARDS:	WDMA Performance attributes meet or exceed WDMA IS-1A and AWS Extra Heavy Duty standards when specified with blocking for surface applied hardware without through bolts	
FIRE RATING:	Positive Pressure Category B or Neutral Pressure Positive Pressure tested in accordance with UBC 7-2 1997, UL-10C and NFPA 252 Neutral Pressure with hose stream tested in accordance with UBC-7 1994 and UL-10B For additional information on fire doors please refer to the Lynden Door Fire Door Technical Sheets.	Option: Positive Pressure Category A
ACOUSTICAL RATING	Information presently not available	
ENVIRONMENTAL Attributes:	Recycled content, regionally manufactured, may apply – see GREENDOR™ Contribution Sheets.	

Manufacturing Options

BLOCKING:	Special blocking options may be specified. (Reference WDMA I.S.1A blocking options HB-1 through HB-8)	
MACHINING:	Machining for hardware, open cutouts, installation of lifes and louvers, applied moldings, plant ons, raceways, concealed vertical rods - Hardware cutouts shall be factory machined from manufacturers' templates and shop drawings.	
TRANSPARENT FINISH	WDMA TR6 / AWS System 9 -UV cured catalyzed polyurethane finishes in standard and custom match stains	Options: Other finish systems available
OPAQUE FINISH:	Factory painting in standard and custom match colors	Options: Standard or color tinted priming available