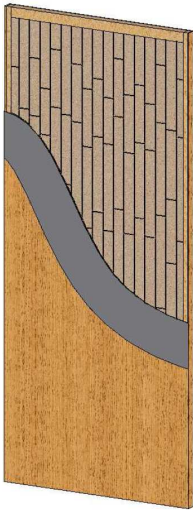

**Lynden Door
Architectural Series**
**LD3000 SLC
Stave Lumber Core Lead Lined Core**
Non Rated or 20 min.

FACES:	HPVA Architectural "A" grade wood veneer (minimum thickness 1/50" before sanding) Options: "AA" grade wood veneer, paint grade MDO Hardboard (SLC3)	
SUBSTRATE:	Engineered wood composites	
CORE:	Wood Stave Lumber WDMA I.S. 1-A C-3	
STILES:	(CE) Compatible with face veneer, mill option AWS Type A wood or Type B veneered Option: (ME) Matching with face veneer	
RAILS:	Mill option structural composite lumber, wood or composite material	
ASSEMBLY:	Stiles and rails are securely bonded to the core and the assembled unit is sanded prior to application of faces	
ADHESIVES:	Type 1	
MAXIMUM SIZE:	POSITIVE PRESSURE WITH HOSE STREAM 4'0" x 9'0" (1220mm x 2743mm)	NEUTRAL PRESSURE WITH HOSE STREAM 4'0 x 10'0 (1220mm x 3050mm)
THICKNESS:	20 min rated 1 3/4" (45 mm) Non-rated 1 3/8" (35 mm) or 1 3/4" (45 mm)	Option: Up to 2 1/2" (63.5 mm) Option: Up to 2 1/2" (63.5 mm)

WARRANTY:	Life of original installation for interior use only See warranty terms and conditions	
STANDARDS:	WDMA IS-1A and AWS Custom Grade Performance attributes meet or exceed WDMA IS-1A and AWS Extra Heavy Duty standards	Option: WDMA IS-1A and AWS Premium Grade
FIRE RATING:	Positive Pressure Category B or Neutral Pressure Positive Pressure tested in accordance with UBC 7-2 1997, UL-10C and NFPA 252 Neutral Pressure with hose stream tested in accordance with UBC-7 1994 and UL-10B For additional information on fire doors please refer to the Lynden Door Fire Door Technical Sheets	Option: Positive Pressure Category A
LEAD SHIELDING	Standard 4lbs with 1/32"(0.8mm) shielding layered between the core/frame assembly and the face on each side of the door, thereby eliminating the requirement for most shielding of hardware. Heavier shielding available upon request	
ACOUSTICAL RATING:	Information presently not available.	
ENVIRONMENTAL Attributes:	Recycled content, regionally recovered and manufactured, may apply – see GREENDOR™ Contribution Sheets	

Manufacturing Options

BLOCKING:	No additional blocking required. Core material complies with Screw holding WDMA TM-10 extra heavy duty	
MACHINING:	Machining for hardware, open cutouts, installation of lites and louvers, applied moldings, plant ons, raceways, concealed vertical rods, decorative routing, dutch doors, doors and transoms - Hardware cutouts shall be factory machined from manufacturers' templates and shop drawings Note: Lynden Door, Inc recommends the use of an appropriate continuous hinge for best performance of this door. When pivots are specified, it is recommended that intermediate pivot(s) be used in conjunction with top and bottom offset pivots. When hinges are specified, it is recommended that heavy weight hinges be used.	
TRANSPARENT FINISH:	WDMA TR6 / AWS System 9 -UV cured catalyzed polyurethane finishes in standard and custom match stains	Options: Other finish systems available
OPAQUE FINISH:	Factory painting in standard and custom match colors	Options: Standard or color tinted priming available