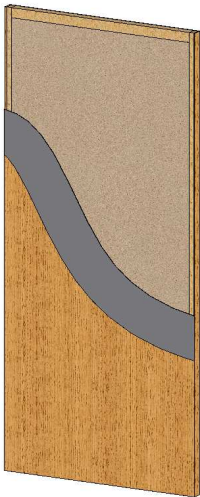

**Lynden Door
Architectural Series**
GREENDOR™
**LD4500 NAUF FD-45-5
Mineral Core
NAUF
45 min. Rated**

FACES:	HPVA Architectural "A" grade wood veneer (minimum thickness 1/50" before sanding) Options: "AA" grade wood veneer, paint grade MDO Hardboard (FD-45-3)	
SUBSTRATE:	Engineered wood composites	
CORE:	Fire rated mineral	
STILES:	(CE) Compatible with face veneer, fire rated composite with outer band of mill option AWS Type A wood or Type B veneered Option: (ME) Matching with face veneer	
RAILS:	Mill option fire rated composite material.	
ASSEMBLY:	Bonded assembly in compliance with fire door listings.	
ADHESIVES:	Type 1	
MAXIMUM SIZE:	POSITIVE PRESSURE WITH HOSE STREAM 4'0" x 9'0" (1220mm x 2743mm)	NEUTRAL PRESSURE WITH HOSE STREAM 4'0 x 10'0 (1220mm x 3050mm)
THICKNESS:	1 ¾" (45 mm)	Option: Up to 2 ½" (63.5 mm) <small>MAXIMUM SIZE 4'0 x 9'0 (1220 mm x 2743mm)</small>

WARRANTY:	Life of original installation for interior use only. See warranty terms and conditions	
STANDARDS:	WDMA IS-1A and AWS Custom Grade Performance attributes meet or exceed WDMA IS-1A and AWS Extra Heavy Duty standards when specified with blocking for surface applied hardware without through bolts.	Option: WDMA IS-1A and AWS Premium Grade
FIRE RATING:	Positive Pressure Category B or Neutral Pressure Positive Pressure tested in accordance with UBC 7-2 1997, UL-10C and NFPA 252 Neutral Pressure with hose stream tested in accordance with UBC-7 1994 and UL-10B For additional information on fire doors please refer to the Lynden Door Fire Door Technical Sheets.	Option: Positive Pressure Category A
ACOUSTICAL RATING	Information presently not available.	
ENVIRONMENTAL Attributes:	All adhesives and binders in this product contain no added urea-formaldehyde. This product is manufactured with pre-consumer recycled material. This product may contribute to credits requiring regional manufacturing. For additional information on product contribution please refer to the GREENDOR™ Contribution Sheets.	

Manufacturing Options

BLOCKING:	Special blocking options may be specified. (Reference WDMA I.S.1A blocking options HB-1 through HB-8)	
MACHINING:	Machining for hardware, open cutouts, installation of lites and louvers, applied moldings, plant ons, raceways, concealed vertical rods, decorative routing, dutch doors, doors and transoms - Hardware cutouts shall be factory machined from manufacturers' templates and shop drawings.	
TRANSPARENT FINISH	WDMA TR6 / AWS System 9 -UV cured catalyzed polyurethane finishes in standard and custom match stains	Options: Other finish systems available
OPAQUE FINISH:	Factory painting in standard and custom match colors	Options: Standard or color tinted priming available