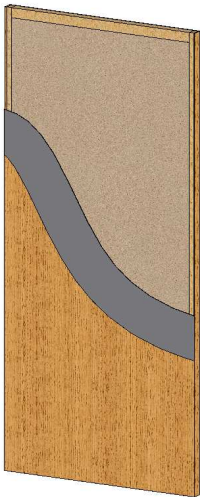

**Lynden Door
Architectural Series
GREENDOR™**
**LD45AG FSC NAUF FD-45-5
Agfiber Particleboard Core
FSC CoC-NAUF
45 min. Rated**

FACES:	HPVA Architectural "A" grade wood veneer (minimum thickness 1/50" before sanding) Options: "AA" grade wood veneer, paint grade MDO Hardboard (FD-45-3)
SUBSTRATE:	Engineered wood composites
CORE:	Fire rated Agfiber particleboard ANSI A208.1 LD2
STILES:	(CE) Compatible with face veneer, mill option AWS Type A wood or Type B veneered Option: (ME) Matching with face veneer
RAILS:	Mill option structural composite lumber, wood or composite material.
ASSEMBLY:	Stiles and rails are securely bonded to the core and the assembled unit is sanded prior to application of faces.
ADHESIVES:	Type 1
MAXIMUM SIZE:	POSITIVE PRESSURE OR NEUTRAL PRESSURE WITH HOSE STREAM 4'0" x 8'0" (1219mm x 2438mm)
THICKNESS:	1 3/4" (45 mm) Option: Up to 2" (51 mm)

WARRANTY:	Life of original installation for interior use only. See warranty terms and conditions	
STANDARDS:	WDMA IS-1A and AWS Custom Grade	Option: WDMA IS-1A and AWS Premium Grade
	Performance attributes meet or exceed WDMA IS-1A and AWS Extra Heavy Duty standards when specified with blocking for surface applied hardware without through bolts.	
FIRE RATING:	Positive Pressure Category B or Neutral Pressure	Option: Positive Pressure Category A
	Positive Pressure tested in accordance with UBC 7-2 1997, UL-10C and NFPA 252	
	Neutral Pressure with hose stream tested in accordance with UBC-7 1994 and UL-10B	
	For additional information on fire doors please refer to the Lynden Door Fire Door Technical Sheets.	
ACOUSTICAL RATING	STC 31 ASTM E90-09 – Non operable	OITC 29 ASTM E90-09 – Non operable
ENVIRONMENTAL Attributes:	This product is an FSC Mixed Source product with all the wood in the door being FSC Certified or FSC Controlled. All adhesives and binders in this product contain no added urea-formaldehyde. This product is manufactured with pre-consumer recycled material. This product may contribute to credits requiring regional recovery of raw material and regional manufacturing. This product is manufactured with rapidly renewable agfiber which is grown and harvested annually. For additional information on product contribution please refer to the GREENDOR™ Contribution Sheets.	

Manufacturing Options

BLOCKING:	Special blocking options may be specified. (Reference WDMA I.S.1A blocking options HB-1 through HB-8)	
MACHINING:	Machining for hardware, open cutouts, installation of lites and louvers, applied moldings, plant ons, raceways, concealed vertical rods - Hardware cutouts shall be factory machined from manufacturers' templates and shop drawings.	
TRANSPARENT FINISH	WDMA TR6 / AWS System 9 -UV cured catalyzed polyurethane finishes in standard and custom match stains	Options: Other finish systems available
OPAQUE FINISH:	Factory painting in standard and custom match colors	Options: Standard or color tinted priming available