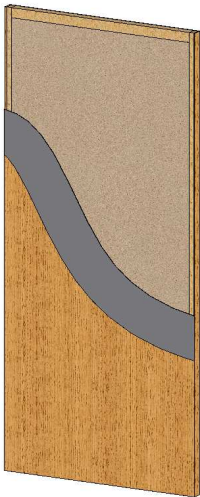

**Lynden Door  
Architectural Series**  
**GREENDOR™**
**LD6000 NAUF FD-60-5  
Mineral Core  
NAUF  
60 min. Rated**

<b>FACES:</b>	HPVA Architectural "A" grade wood veneer (minimum thickness 1/50" before sanding) <b>Options:</b> "AA" grade wood veneer, paint grade MDO Hardboard (FD-60-3)	
<b>SUBSTRATE:</b>	Engineered wood composites	
<b>CORE:</b>	Fire rated mineral	
<b>STILES:</b>	(CE) Compatible with face veneer, fire rated composite with outer band of mill option AWS Type A wood or Type B veneered <b>Option:</b> (ME) Matching with face veneer	
<b>RAILS:</b>	Mill option fire rated composite material.	
<b>ASSEMBLY:</b>	Bonded assembly in compliance with fire door listings.	
<b>ADHESIVES:</b>	Type 1	
<b>MAXIMUM SIZE:</b>	<b>POSITIVE PRESSURE WITH HOSE STREAM</b> 4'0" x 9'0" (1220mm x 2743mm)	<b>NEUTRAL PRESSURE WITH HOSE STREAM</b> 4'0 x 10'0 (1220mm x 3050mm)
<b>THICKNESS:</b>	1 ¾" (45 mm)	<b>Option:</b> Up to 2 ½" (63.5 mm) <small>MAXIMUM SIZE 4'0 x 9'0 (1220 mm x 2743mm)</small>

<b>WARRANTY:</b>	Life of original installation for interior use only. See warranty terms and conditions	
<b>STANDARDS:</b>	WDMA IS-1A and AWS Custom Grade Performance attributes meet or exceed WDMA IS-1A and AWS Extra Heavy Duty standards when specified with blocking for surface applied hardware without through bolts.	<b>Option:</b> WDMA IS-1A and AWS Premium Grade
<b>FIRE RATING:</b>	Positive Pressure Category B or Neutral Pressure Positive Pressure tested in accordance with UBC 7-2 1997, UL-10C and NFPA 252 Neutral Pressure with hose stream tested in accordance with UBC-7 1994 and UL-10B For additional information on fire doors please refer to the Lynden Door Fire Door Technical Sheets.	<b>Option:</b> Positive Pressure Category A
<b>ACOUSTICAL RATING</b>	Information presently not available	
<b>ENVIRONMENTAL Attributes:</b>	All adhesives and binders in this product contain no added urea-formaldehyde. This product is manufactured with pre-consumer recycled material. This product may contribute to credits requiring regional manufacturing. For additional information on product contribution please refer to the <b>GREENDOR™</b> Contribution Sheets.	

## Manufacturing Options

<b>BLOCKING:</b>	Special blocking options may be specified. (Reference WDMA I.S.1A blocking options HB-1 through HB-8 )	
<b>MACHINING:</b>	Machining for hardware, open cutouts, installation of lites and louvers, applied moldings, plant ons, raceways, concealed vertical rods, decorative routing, dutch doors, doors and transoms - Hardware cutouts shall be factory machined from manufacturers' templates and shop drawings.	
<b>TRANSPARENT FINISH</b>	WDMA TR6 / AWS System 9 -UV cured catalyzed polyurethane finishes in standard and custom match stains	<b>Options:</b> Other finish systems available
<b>OPAQUE FINISH:</b>	Factory painting in standard and custom match colors	<b>Options:</b> Standard or color tinted priming available