

Denman 6'8" Door Width
3' 0"
2' 10"
2' 8"
2' 6"
2' 4"
2' 2"
2' 0"
1' 10"
1' 8"
1' 6"

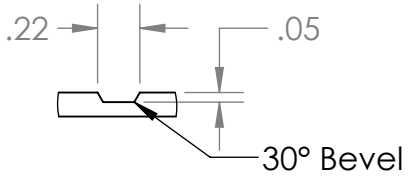

Rout Profile
SCALE 1 : 1

- Notes:**
1. Dimensions are to Centerline of Rout Profile
 2. Line symmetry tolerance at $\pm 1/32"$

DRAWN	KC	07/28/15	MATERIAL	FINISH Primed
CHECKED	CB	10/26/15	Lynden Door, Inc.	
ENG APPR.	-	-		
MFG APPR.	-	-		
Q.A.	-	-		
UNLESS OTHERWISE SPECIFIED: DIMENSIONS ARE IN: Inches TOLERANCES FRACTIONAL: $\pm 1/16$ ANGULAR: MACH ± 2 BEND ± 1 ONE PLACE DECIMAL: ± 1 TWO PLACE DECIMAL: $\pm .02$ THREE PLACE DECIMAL: $\pm .002$			THE INFORMATION CONTAINED IN THIS DRAWING IS THE SOLE PROPERTY OF Lynden Door, Inc. ANY REPRODUCTION IN PART OR AS A WHOLE WITHOUT THE WRITTEN PERMISSION OF Lynden Door, Inc. IS PROHIBITED.	
TITLE: Denman				
SIZE	A	DWG. NO. A04-00028	REV -	
SCALE: 1:12		WEIGHT:	SHEET 1 OF 3	

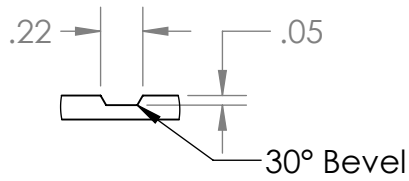
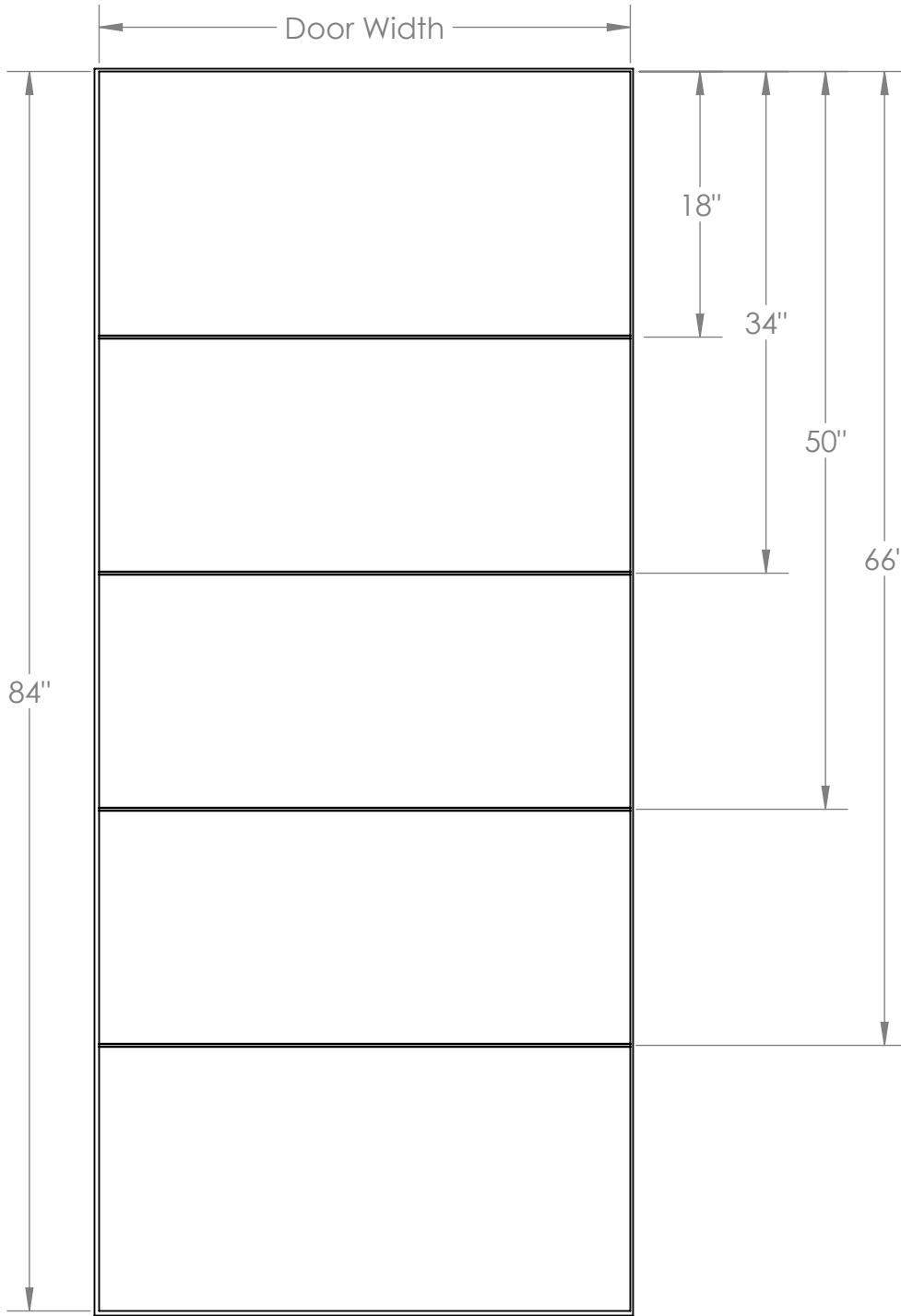

Rout Profile
SCALE 1 : 1

Denman 7'0" Door Width
3' 0"
2' 10"
2' 8"
2' 6"
2' 4"
2' 2"
2' 0"
1' 10"
1' 8"
1' 6"

DRAWN KC	07/28/15	MATERIAL	FINISH Primed	
CHECKED CB	10/26/15	<h1>Lynden Door, Inc.</h1>		
ENG APPR. -	-			
MFG APPR. -	-			
Q.A. -	-			
<small>UNLESS OTHERWISE SPECIFIED: DIMENSIONS ARE IN: Inches TOLERANCES FRACTIONAL: ±1/16 ANGULAR: MACH ±2 BEND ± ONE PLACE DECIMAL: ± TWO PLACE DECIMAL: ±.02 THREE PLACE DECIMAL: ±</small>		<small>THE INFORMATION CONTAINED IN THIS DRAWING IS THE SOLE PROPERTY OF Lynden Door, Inc. ANY REPRODUCTION IN PART OR AS A WHOLE WITHOUT THE WRITTEN PERMISSION OF Lynden Door, Inc. IS PROHIBITED.</small>		
TITLE: Denman		SIZE A	DWG. NO. A04-00028	REV -
DO NOT SCALE DRAWING		SCALE: 1:12	WEIGHT:	SHEET 2 OF 3

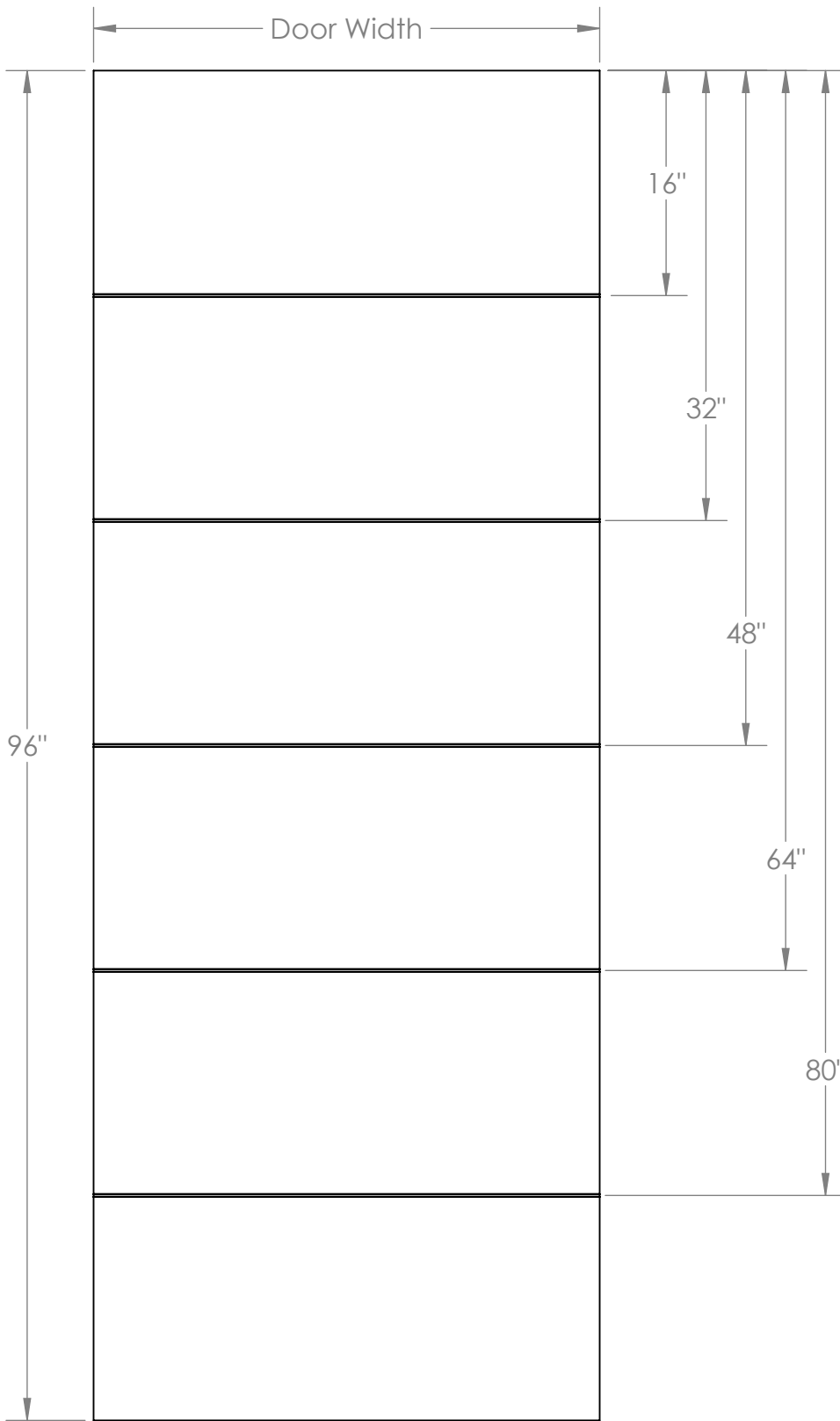

Denman 8'0" Door Width	
3' 0"	
2' 10"	
2' 8"	
2' 6"	
2' 4"	
2' 2"	
2' 0"	
1' 10"	
1' 8"	
1' 6"	

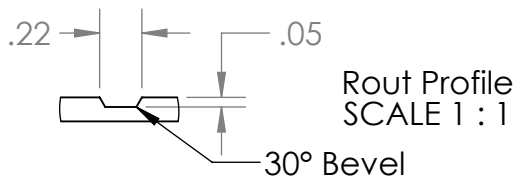

DRAWN	KC	07/28/15	MATERIAL	FINISH Primed	
CHECKED	CB	10/26/15	<h2 style="text-align: center;">Lynden Door, Inc.</h2>		
ENG APPR.	-	-			
MFG APPR.	-	-			
Q.A.	-	-			
<small>UNLESS OTHERWISE SPECIFIED: DIMENSIONS ARE IN: Inches TOLERANCES FRACTIONAL: ±1/16 ANGULAR: MACH ±2 BEND ± </small>			<small>THE INFORMATION CONTAINED IN THIS DRAWING IS THE SOLE PROPERTY OF Lynden Door, Inc. ANY REPRODUCTION IN PART OR AS A WHOLE WITHOUT THE WRITTEN PERMISSION OF Lynden Door, Inc. IS PROHIBITED.</small>		
TITLE: Denman					
SIZE	A	DWG. NO.	A04-00028	REV	-
		SCALE:	1:12	WEIGHT:	
				SHEET 3 OF 3	

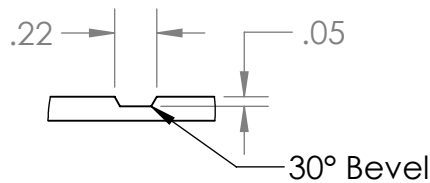
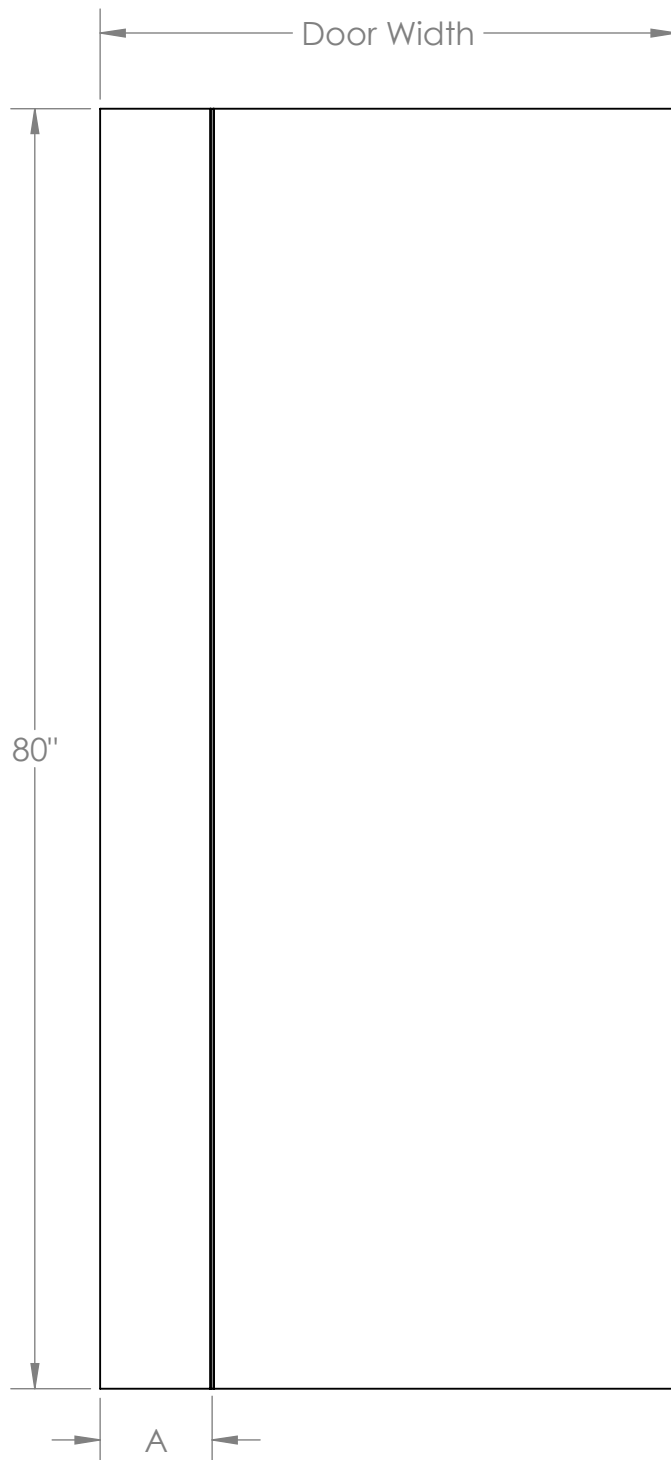

Rout Profile
SCALE 1 : 1

Laurelhurst 6'8"	
Door Width	A
3' 0"	7"
2' 10"	7"
2' 8"	7"
2' 6"	6"
2' 4"	6"
2' 2"	6"
2' 0"	5"
1' 10"	5"
1' 8"	5"
1' 6"	5"

Notes:

1. Dimensions are to Centerline of Rout Profile
2. Line symmetry tolerance at $\pm 1/32"$

DRAWN	KC	07/28/15	MATERIAL	FINISH Primed	
CHECKED	CB	10/26/15	Lynden Door, Inc. <small>THE INFORMATION CONTAINED IN THIS DRAWING IS THE SOLE PROPERTY OF Lynden Door, Inc. ANY REPRODUCTION IN PART OR AS A WHOLE WITHOUT THE WRITTEN PERMISSION OF Lynden Door, Inc. IS PROHIBITED.</small>		
ENG APPR.	-	-			
MFG APPR.	-	-			
Q.A.	-	-			
<small>UNLESS OTHERWISE SPECIFIED: DIMENSIONS ARE IN: Inches TOLERANCES FRACTIONAL: $\pm 1/16$ ANGULAR: MACH ± 2 BEND ± 1 ONE PLACE DECIMAL: ± 1 TWO PLACE DECIMAL: $\pm .02$ THREE PLACE DECIMAL: $\pm .005$</small>			TITLE: Laurelhurst		
SIZE	A	DWG. NO.	A04-00023	REV	-
SCALE: 1:12		WEIGHT:		SHEET 1 OF 3	

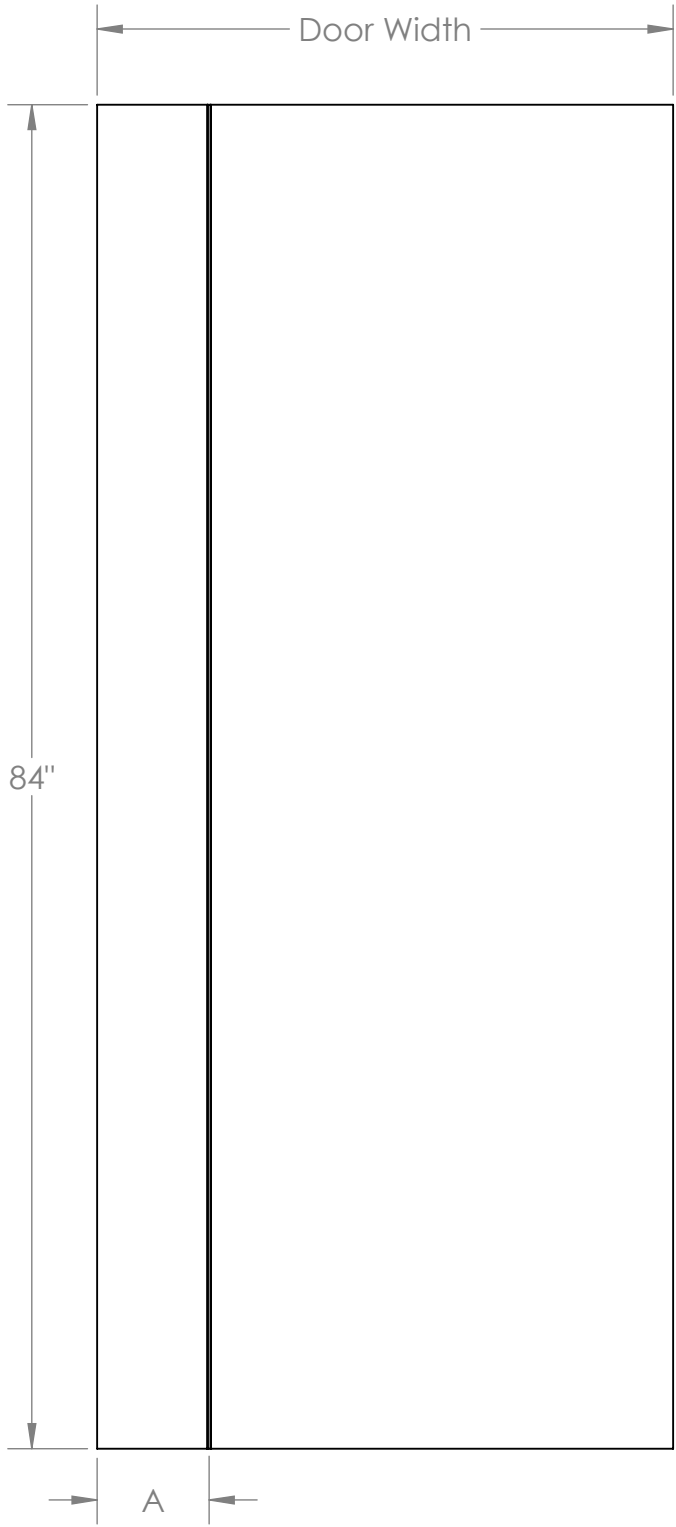

Laurelhurst 7'0"	
Door Width	A
3' 0"	7"
2' 10"	7"
2' 8"	7"
2' 6"	6"
2' 4"	6"
2' 2"	6"
2' 0"	5"
1' 10"	5"
1' 8"	5"
1' 6"	5"

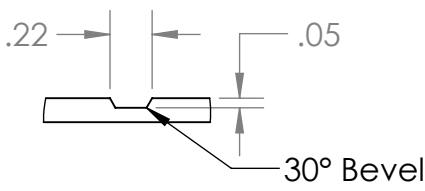

Rout Profile
SCALE 1 : 1

DRAWN	KC	07/28/15	MATERIAL	FINISH Primed	
CHECKED	CB	10/26/15	Lynden Door, Inc. <small>THE INFORMATION CONTAINED IN THIS DRAWING IS THE SOLE PROPERTY OF Lynden Door, Inc. ANY REPRODUCTION IN PART OR AS A WHOLE WITHOUT THE WRITTEN PERMISSION OF Lynden Door, Inc. IS PROHIBITED.</small>		
ENG APPR.	-	-			
MFG APPR.	-	-			
Q.A.	-	-			
<small>UNLESS OTHERWISE SPECIFIED: DIMENSIONS ARE IN: Inches TOLERANCES FRACTIONAL: ±1/16 ANGULAR: MACH ±2 BEND ± ONE PLACE DECIMAL: ± TWO PLACE DECIMAL: ±.02 THREE PLACE DECIMAL: ±</small>					
TITLE: Laurelhurst					
SIZE	A	DWG. NO.	A04-00023	REV	-
		SCALE:	1:12	WEIGHT:	
				SHEET	2 OF 3

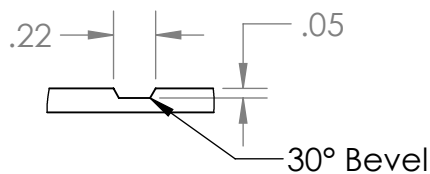
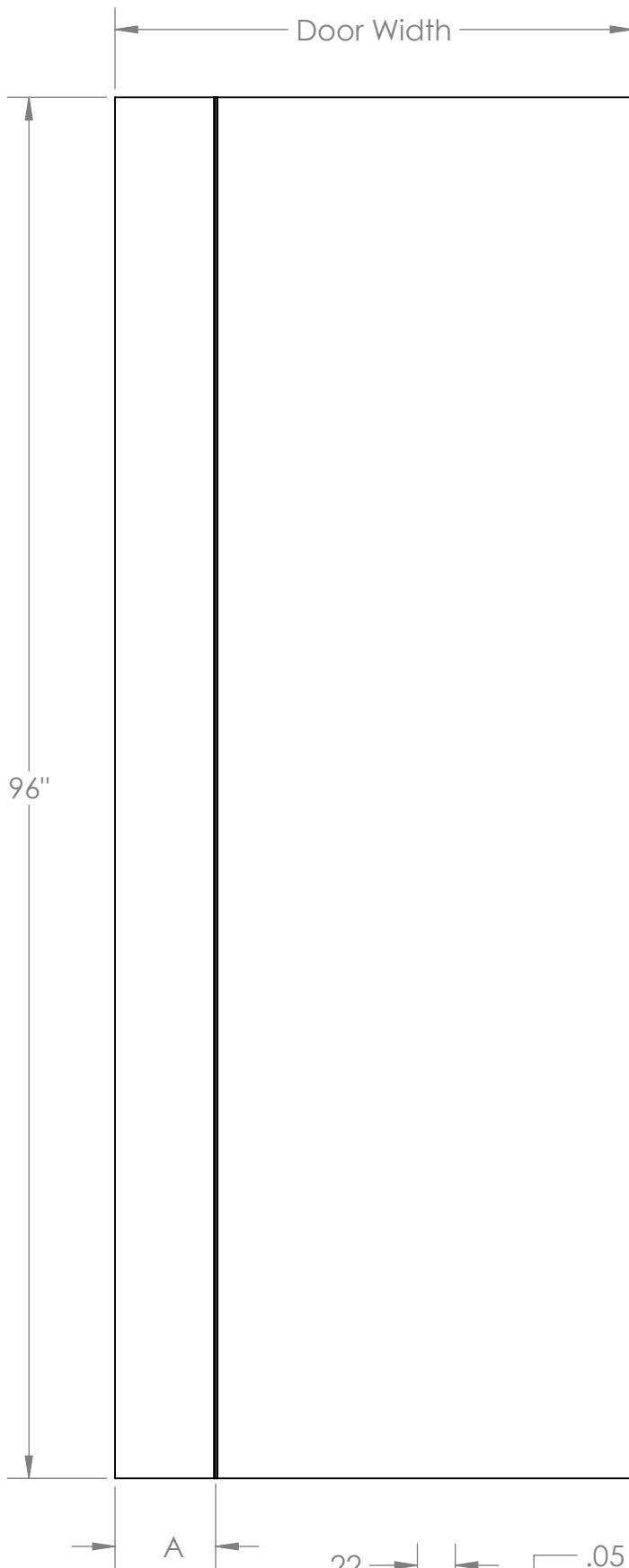

Rout Profile
SCALE 1 : 1

Laurelhurst 8'0"	
Door Width	A
3' 0"	7"
2' 10"	7"
2' 8"	7"
2' 6"	6"
2' 4"	6"
2' 2"	6"
2' 0"	5"
1' 10"	5"
1' 8"	5"
1' 6"	5"

DRAWN	KC	07/28/15	MATERIAL	FINISH Primed	
CHECKED	CB	10/26/15	Lynden Door, Inc. TITLE: Laurelhurst		
ENG APPR.	-	-			
MFG APPR.	-	-			
Q.A.	-	-			
UNLESS OTHERWISE SPECIFIED: DIMENSIONS ARE IN: Inches TOLERANCES FRACTIONAL: ±1/16 ANGULAR: MACH ±2 BEND ± ONE PLACE DECIMAL: ± TWO PLACE DECIMAL: ±.02 THREE PLACE DECIMAL: ±			THE INFORMATION CONTAINED IN THIS DRAWING IS THE SOLE PROPERTY OF Lynden Door, Inc. ANY REPRODUCTION IN PART OR AS A WHOLE WITHOUT THE WRITTEN PERMISSION OF Lynden Door, Inc. IS PROHIBITED.		
SIZE	A	DWG. NO.	A04-00023	REV	-
		SCALE:	1:12	WEIGHT:	
				SHEET	3 OF 3

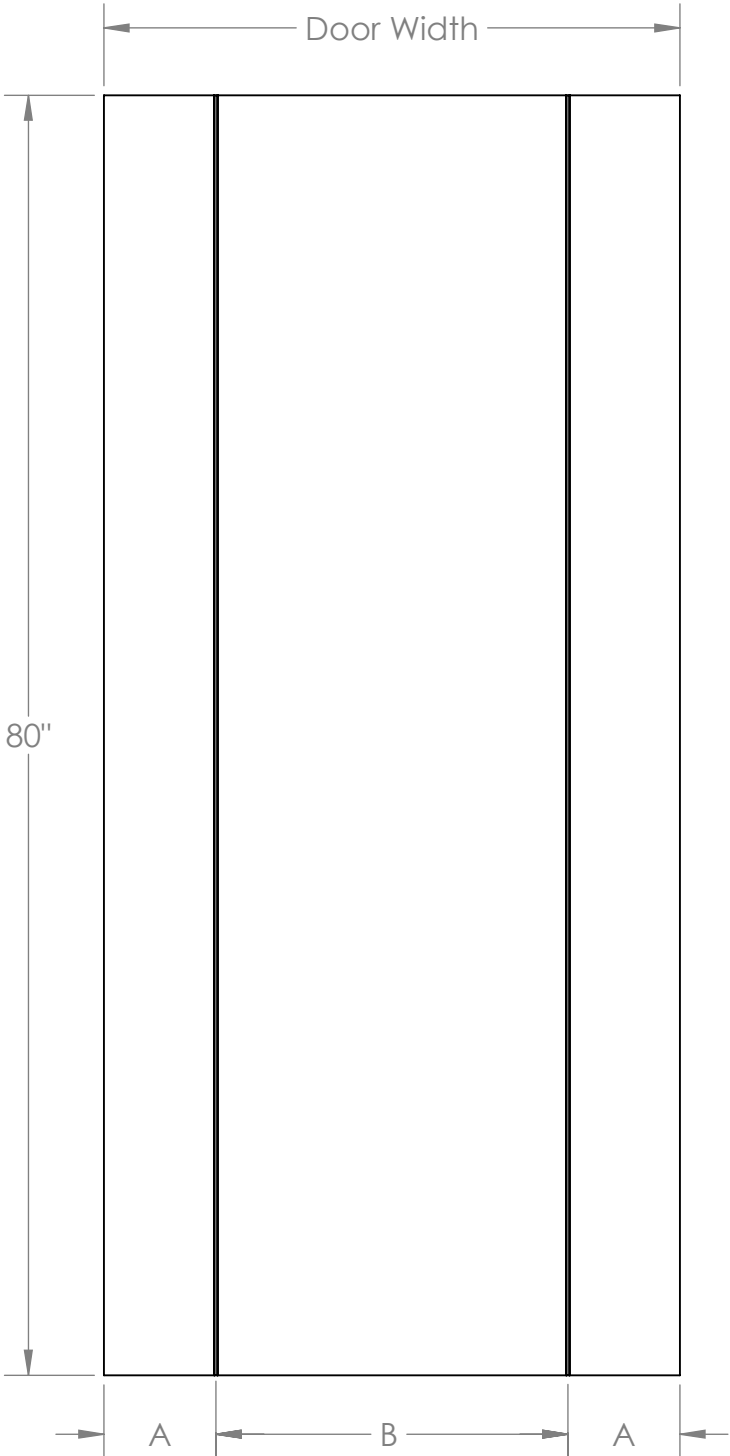

Parkrose 6'8"		
Door Width	A	B
3' 0"	7"	22"
2' 10"	7"	20"
2' 8"	7"	18"
2' 6"	6"	18"
2' 4"	6"	16"
2' 2"	6"	14"
2' 0"	5"	14"
1' 10"	5"	12"
1' 8"	5"	10"
1' 6"	5"	8"

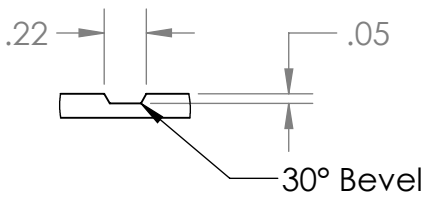

Root Profile
SCALE 1 : 1

- Notes:**
- Dimensions are to Centerline of Root Profile
 - Line symmetry tolerance at $\pm 1/32"$

DRAWN	KC	07/28/15	MATERIAL	FINISH Primed
CHECKED	CB	10/26/15	Lynden Door, Inc. THE INFORMATION CONTAINED IN THIS DRAWING IS THE SOLE PROPERTY OF Lynden Door, Inc. ANY REPRODUCTION IN PART OR AS A WHOLE WITHOUT THE WRITTEN PERMISSION OF Lynden Door, Inc. IS PROHIBITED.	
ENG APPR.	-	-		
MFG APPR.	-	-		
Q.A.	-	-		
<small>UNLESS OTHERWISE SPECIFIED: DIMENSIONS ARE IN: Inches TOLERANCES FRACTIONAL: $\pm 1/16$ ANGULAR: MACH ± 2 BEND ± 1 ONE PLACE DECIMAL: ± 1 TWO PLACE DECIMAL: $\pm .02$ THREE PLACE DECIMAL: $\pm .005$</small>				
TITLE: Parkrose			SIZE A	DWG. NO. A04-00024
DO NOT SCALE DRAWING			SCALE: 1:12	WEIGHT:
			REV -	SHEET 1 OF 3

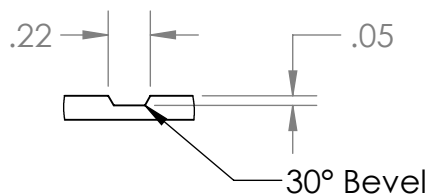
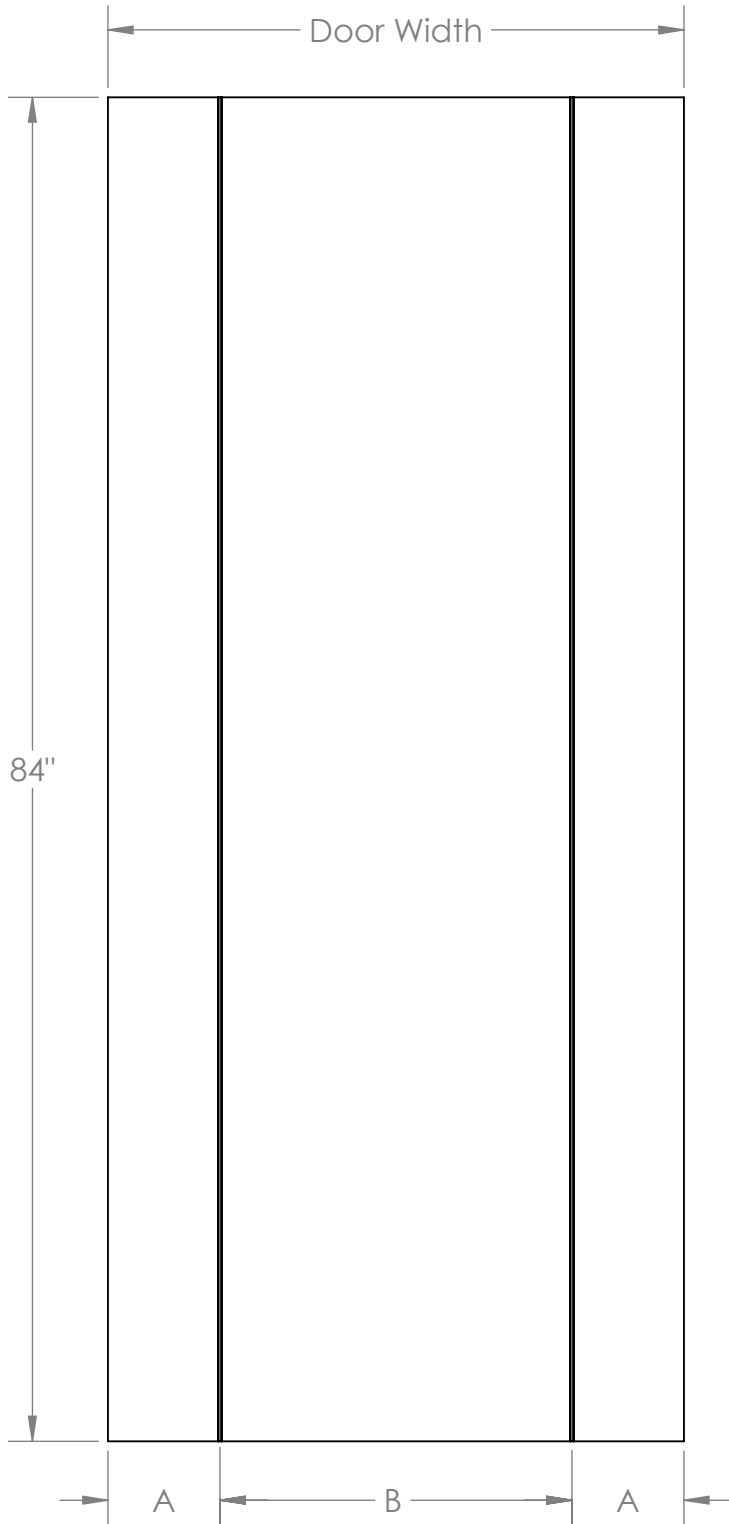

Rout Profile
SCALE 1 : 1

Parkrose 7'0"		
Door Width	A	B
3' 0"	7"	22"
2' 10"	7"	20"
2' 8"	7"	18"
2' 6"	6"	18"
2' 4"	6"	16"
2' 2"	6"	14"
2' 0"	5"	14"
1' 10"	5"	12"
1' 8"	5"	10"
1' 6"	5"	8"

DRAWN	KC	07/28/15	MATERIAL	FINISH Primed	
CHECKED	CB	10/26/15	Lynden Door, Inc. THE INFORMATION CONTAINED IN THIS DRAWING IS THE SOLE PROPERTY OF Lynden Door, Inc. ANY REPRODUCTION IN PART OR AS A WHOLE WITHOUT THE WRITTEN PERMISSION OF Lynden Door, Inc. IS PROHIBITED.		
ENG APPR.	-	-			
MFG APPR.	-	-			
Q.A.	-	-			
<small>UNLESS OTHERWISE SPECIFIED: DIMENSIONS ARE IN: Inches TOLERANCES FRACTIONAL: ±1/16 ANGULAR: MACH ±2 BEND ± ONE PLACE DECIMAL: ± TWO PLACE DECIMAL: ±.02 THREE PLACE DECIMAL: ±</small>			TITLE: Parkrose		
SIZE	A	DWG. NO.	A04-00024	REV	-
DO NOT SCALE DRAWING		SCALE:	1:12	WEIGHT:	
				SHEET	2 OF 3

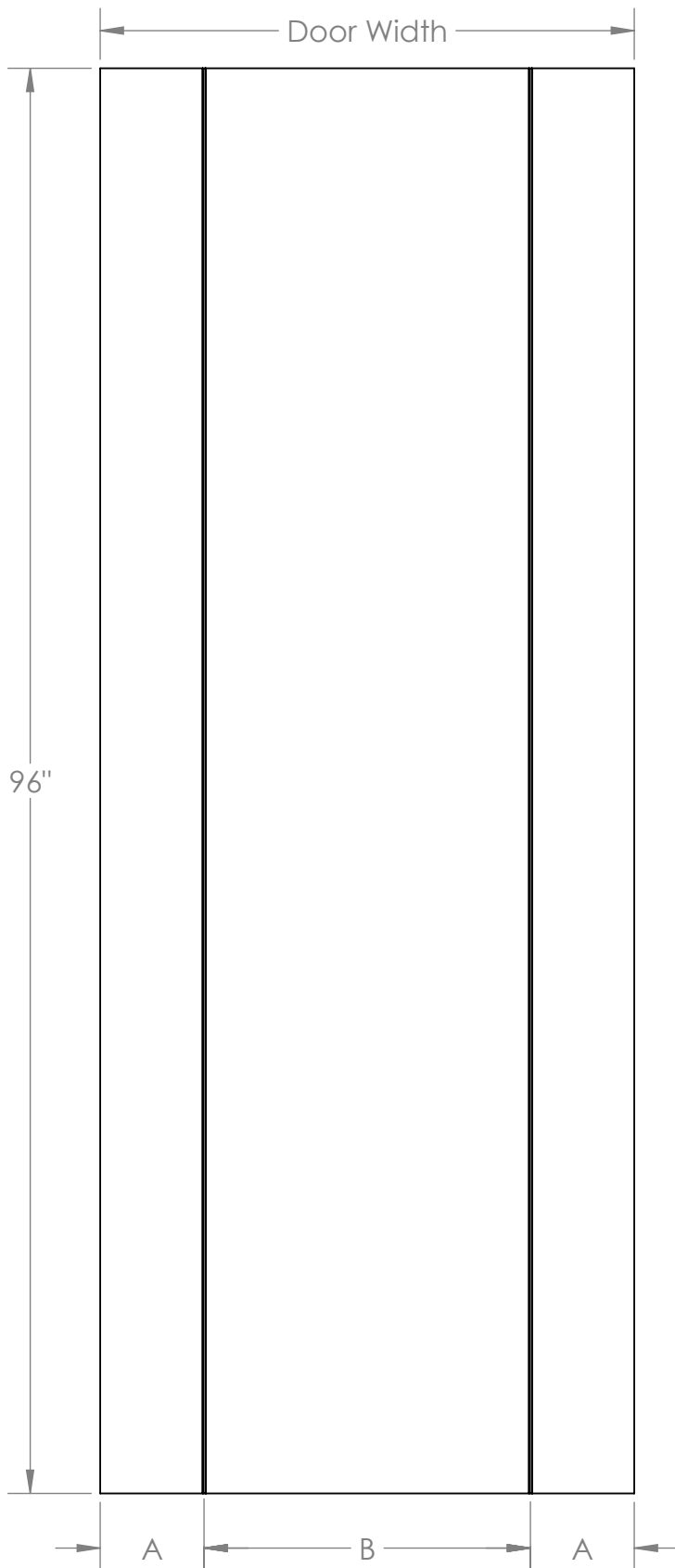

Parkrose 8'0"		
Door Width	A	B
3' 0"	7"	22"
2' 10"	7"	20"
2' 8"	7"	18"
2' 6"	6"	18"
2' 4"	6"	16"
2' 2"	6"	14"
2' 0"	5"	14"
1' 10"	5"	12"
1' 8"	5"	10"
1' 6"	5"	8"

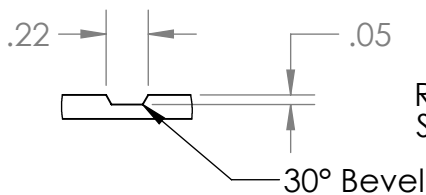

Route Profile
SCALE 1 : 1

DRAWN	KC	07/28/15	MATERIAL	FINISH Primed	
CHECKED	CB	10/26/15	<h2>Lynden Door, Inc.</h2>		
ENG APPR.	-	-			
MFG APPR.	-	-			
Q.A.	-	-			
<small>UNLESS OTHERWISE SPECIFIED: DIMENSIONS ARE IN: Inches TOLERANCES FRACTIONAL: ±1/16 ANGULAR: MACH ±2 BEND ± ONE PLACE DECIMAL: ± TWO PLACE DECIMAL: ±.02 THREE PLACE DECIMAL: ±</small>			<small>THE INFORMATION CONTAINED IN THIS DRAWING IS THE SOLE PROPERTY OF Lynden Door, Inc. ANY REPRODUCTION IN PART OR AS A WHOLE WITHOUT THE WRITTEN PERMISSION OF Lynden Door, Inc. IS PROHIBITED.</small>		
TITLE: Parkrose					
SIZE	A	DWG. NO.	A04-00024	REV	-
		SCALE:	1:12	WEIGHT:	
				SHEET	3 OF 3

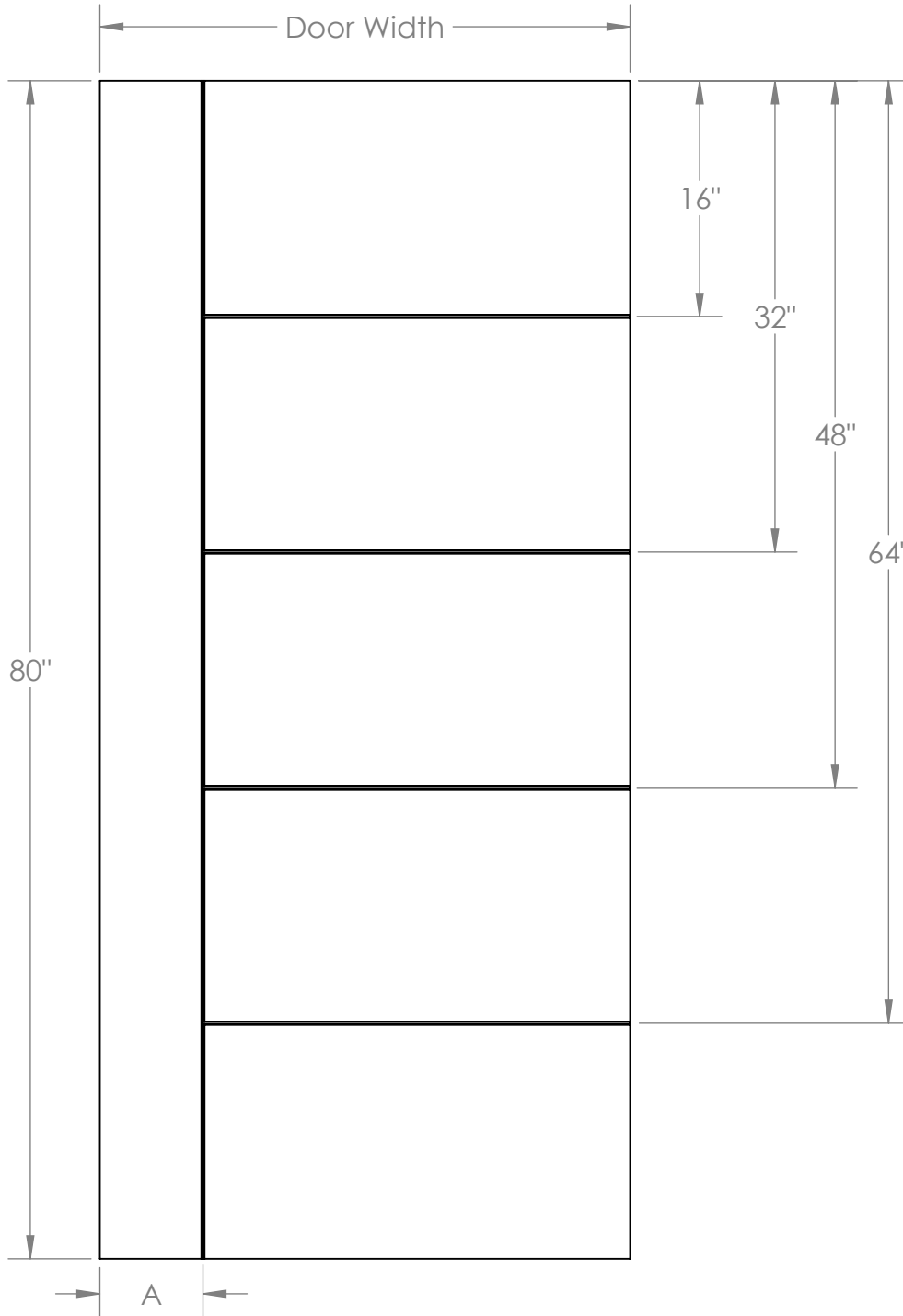

Alki 6'8"	
Door Width	A
3' 0"	7"
2' 10"	7"
2' 8"	7"
2' 6"	6"
2' 4"	6"
2' 2"	6"
2' 0"	5"
1' 10"	5"
1' 8"	5"
1' 6"	5"

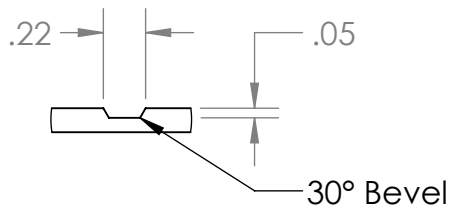

Rout Profile
SCALE 1 : 1

Notes:

1. Dimensions are to Centerline of Rout Profile
2. Line symmetry tolerance at $\pm 1/32"$

DRAWN	KC	07/28/15	MATERIAL	FINISH Primed
CHECKED	CB	10/26/15	Lynden Door, Inc.	
ENG APPR.	-	-		
MFG APPR.	-	-		
Q.A.	-	-		
UNLESS OTHERWISE SPECIFIED: DIMENSIONS ARE IN: Inches TOLERANCES FRACTIONAL: $\pm 1/16$ ANGULAR: MACH ± 2 BEND ± 1 ONE PLACE DECIMAL: $\pm .02$ TWO PLACE DECIMAL: $\pm .01$ THREE PLACE DECIMAL: $\pm .005$			THE INFORMATION CONTAINED IN THIS DRAWING IS THE SOLE PROPERTY OF Lynden Door, Inc. ANY REPRODUCTION IN PART OR AS A WHOLE WITHOUT THE WRITTEN PERMISSION OF Lynden Door, Inc. IS PROHIBITED.	
TITLE: Alki			SIZE A	DWG. NO. A04-00025
DO NOT SCALE DRAWING			SCALE: 1:12	WEIGHT:
				REV -
				SHEET 1 OF 3

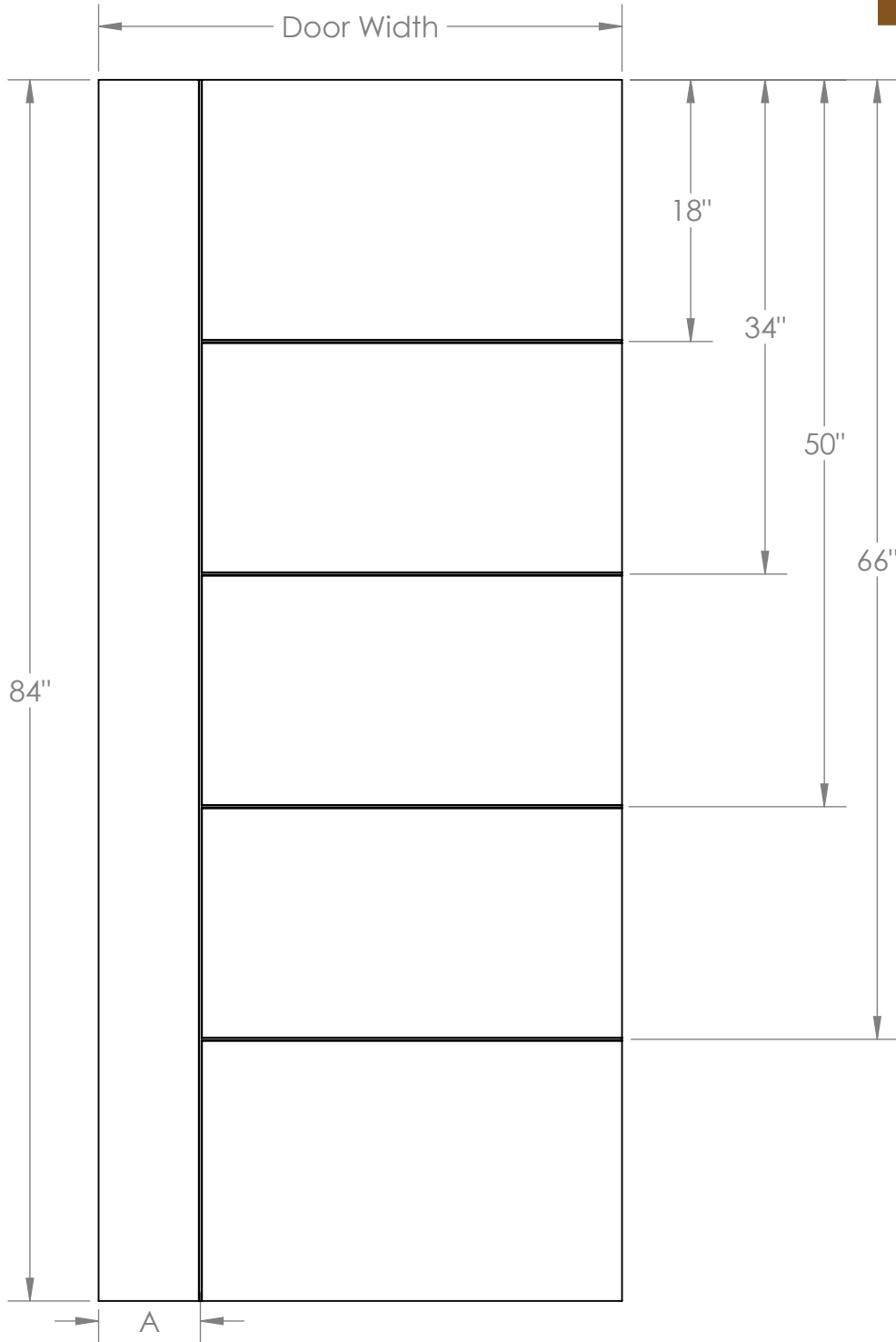

Alki 7'0"	
Door Width	A
3' 0"	7"
2' 10"	7"
2' 8"	7"
2' 6"	6"
2' 4"	6"
2' 2"	6"
2' 0"	5"
1' 10"	5"
1' 8"	5"
1' 6"	5"

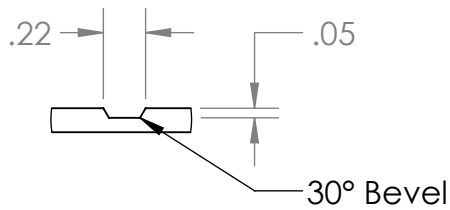

Rout Profile
SCALE 1 : 1

DRAWN	KC	07/28/15	MATERIAL	FINISH Primed	
CHECKED	CB	10/26/15	<h2 style="text-align: center;">Lynden Door, Inc.</h2>		
ENG APPR.	-	-			
MFG APPR.	-	-			
Q.A.	-	-			
<small>UNLESS OTHERWISE SPECIFIED: DIMENSIONS ARE IN: Inches TOLERANCES FRACTIONAL: ±1/16 ANGULAR: MACH ±2 BEND ± ONE PLACE DECIMAL: ± TWO PLACE DECIMAL: ±.02 THREE PLACE DECIMAL: ±</small>			<small>THE INFORMATION CONTAINED IN THIS DRAWING IS THE SOLE PROPERTY OF Lynden Door, Inc. ANY REPRODUCTION IN PART OR AS A WHOLE WITHOUT THE WRITTEN PERMISSION OF Lynden Door, Inc. IS PROHIBITED.</small>		
TITLE: Alki			SIZE A	DWG. NO. A04-00025	REV -
DO NOT SCALE DRAWING			SCALE: 1:12	WEIGHT:	SHEET 2 OF 3

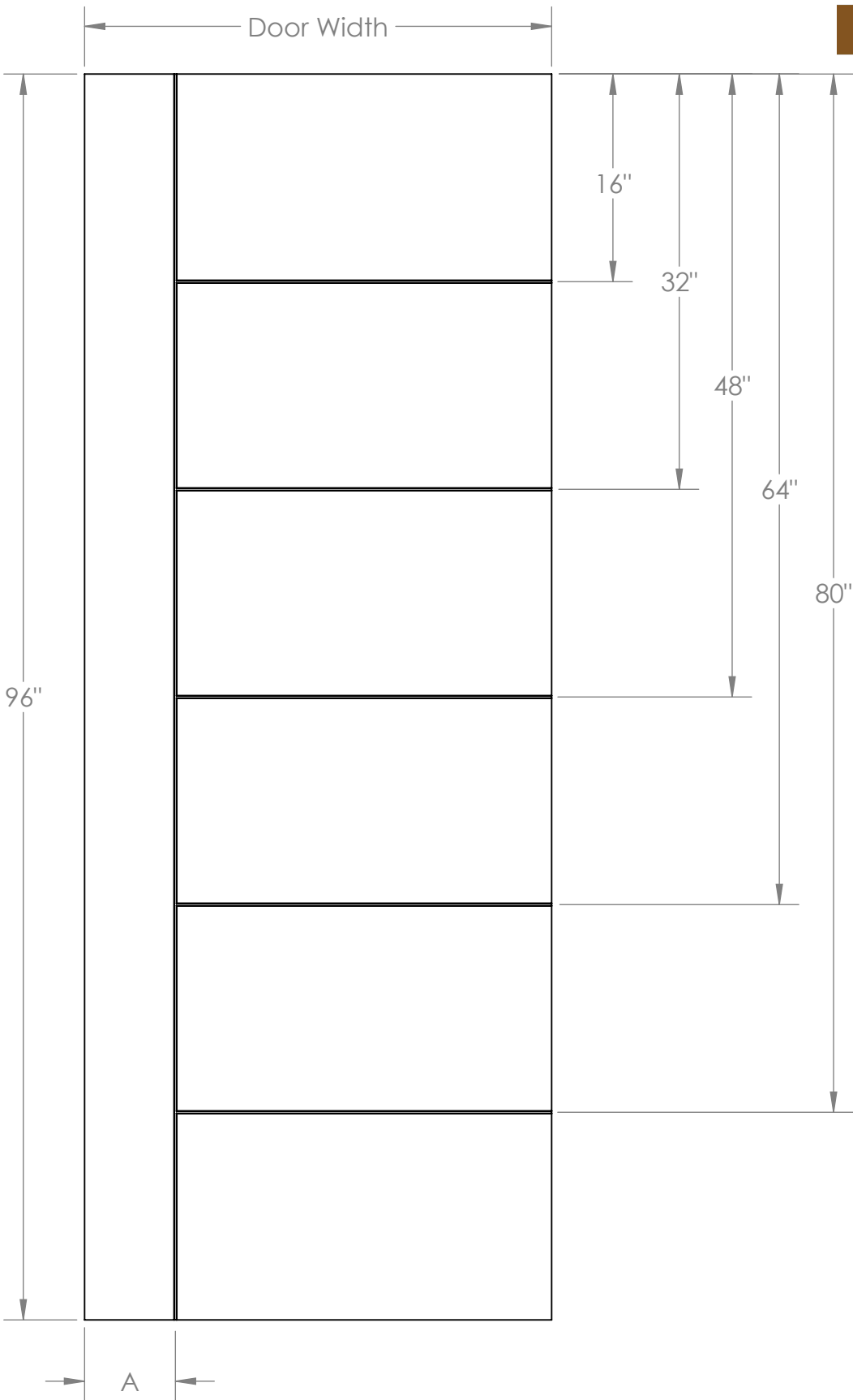

Alki 8'0"	
Door Width	A
3' 0"	7"
2' 10"	7"
2' 8"	7"
2' 6"	6"
2' 4"	6"
2' 2"	6"
2' 0"	5"
1' 10"	5"
1' 8"	5"
1' 6"	5"

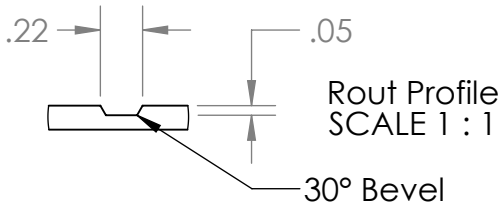

DRAWN	KC	07/28/15	MATERIAL	FINISH Primed	
CHECKED	CB	10/26/15	<h2>Lynden Door, Inc.</h2>		
ENG APPR.	-	-			
MFG APPR.	-	-			
Q.A.	-	-			
<small>UNLESS OTHERWISE SPECIFIED: DIMENSIONS ARE IN: Inches TOLERANCES FRACTIONAL: ±1/16 ANGULAR: MACH ±2 BEND ± ONE PLACE DECIMAL: ± TWO PLACE DECIMAL: ±.02 THREE PLACE DECIMAL: ±</small>			<small>THE INFORMATION CONTAINED IN THIS DRAWING IS THE SOLE PROPERTY OF Lynden Door, Inc. ANY REPRODUCTION IN PART OR AS A WHOLE WITHOUT THE WRITTEN PERMISSION OF Lynden Door, Inc. IS PROHIBITED.</small>		
TITLE: Alki					
SIZE	A	DWG. NO.	A04-00025	REV	-
		SCALE:	1:12	WEIGHT:	
				SHEET	3 OF 3

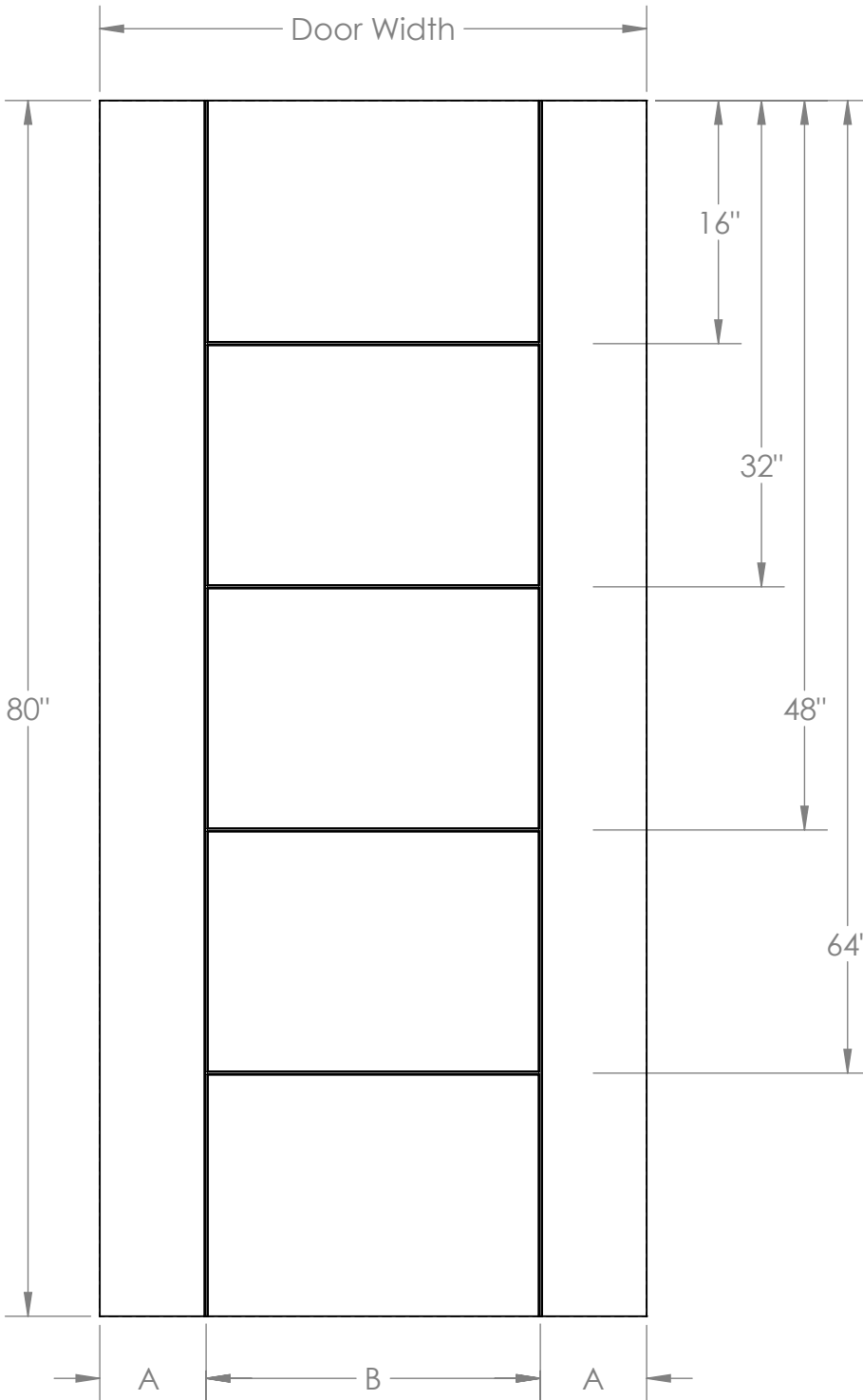

Robson 6'8"		
Door Width	A	B
3' 0"	7"	22"
2' 10"	7"	20"
2' 8"	7"	18"
2' 6"	6"	18"
2' 4"	6"	16"
2' 2"	6"	14"
2' 0"	5"	14"
1' 10"	5"	12"
1' 8"	5"	10"
1' 6"	5"	8"

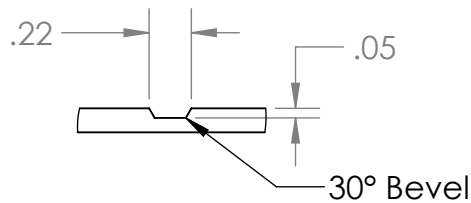

Root Profile
SCALE 1 : 1

Notes:

1. Dimensions are to Centerline of Root Profile
2. Line symmetry tolerance at $\pm 1/32"$

DRAWN	KC	07/28/15	MATERIAL	FINISH Primed	
CHECKED	CB	10/26/15	<h2 style="text-align: center;">Lynden Door, Inc.</h2>		
ENG APPR.	-	-			
MFG APPR.	-	-			
Q.A.	-	-			
<small>UNLESS OTHERWISE SPECIFIED: DIMENSIONS ARE IN: Inches TOLERANCES FRACTIONAL: $\pm 1/16$ ANGULAR: MACH ± 2 BEND ± 1 ONE PLACE DECIMAL: ± 1 TWO PLACE DECIMAL: $\pm .02$ THREE PLACE DECIMAL: $\pm .002$</small>			<small>THE INFORMATION CONTAINED IN THIS DRAWING IS THE SOLE PROPERTY OF Lynden Door, Inc. ANY REPRODUCTION IN PART OR AS A WHOLE WITHOUT THE WRITTEN PERMISSION OF Lynden Door, Inc. IS PROHIBITED.</small>		
TITLE:			Robson		
SIZE	A	DWG. NO.	A04-00026	REV	-
SCALE:		1:12	WEIGHT:	SHEET 1 OF 3	

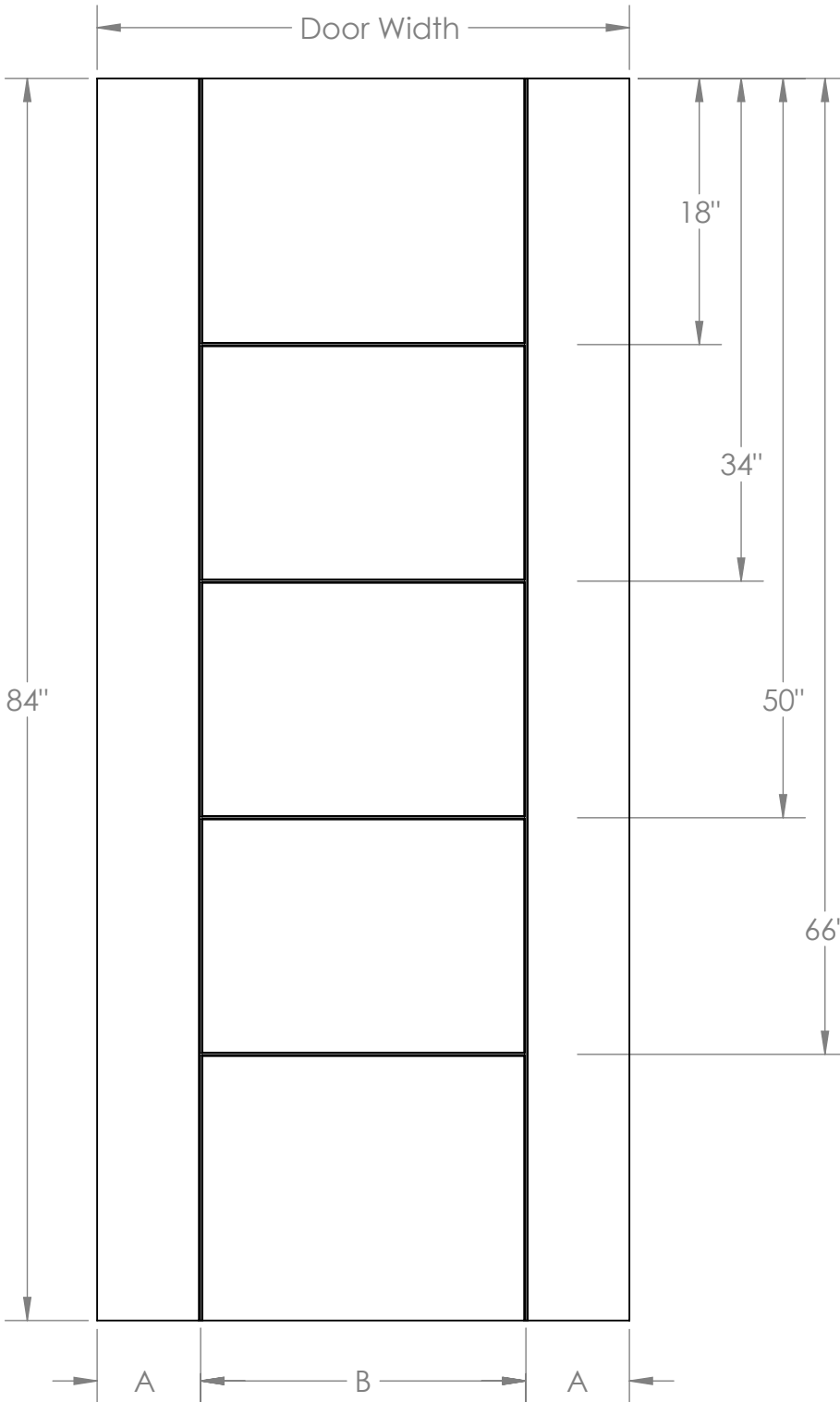

Robson 7'0"		
Door Width	A	B
3' 0"	7"	22"
2' 10"	7"	20"
2' 8"	7"	18"
2' 6"	6"	18"
2' 4"	6"	16"
2' 2"	6"	14"
2' 0"	5"	14"
1' 10"	5"	12"
1' 8"	5"	10"
1' 6"	5"	8"

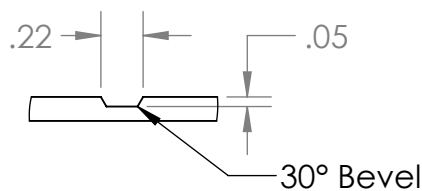

Rout Profile
SCALE 1 : 1

DRAWN	KC	07/28/15	MATERIAL	FINISH Primed	
CHECKED	CB	10/26/15	<h2 style="margin: 0;">Lynden Door, Inc.</h2>		
ENG APPR.	-	-			
MFG APPR.	-	-			
Q.A.	-	-			
<small>UNLESS OTHERWISE SPECIFIED: DIMENSIONS ARE IN: Inches TOLERANCES FRACTIONAL: ±1/16 ANGULAR: MACH ±2 BEND ± ONE PLACE DECIMAL: ± TWO PLACE DECIMAL: ±.02 THREE PLACE DECIMAL: ±</small>			<small>THE INFORMATION CONTAINED IN THIS DRAWING IS THE SOLE PROPERTY OF Lynden Door, Inc. ANY REPRODUCTION IN PART OR AS A WHOLE WITHOUT THE WRITTEN PERMISSION OF Lynden Door, Inc. IS PROHIBITED.</small>		
TITLE: Robson			SIZE A	DWG. NO. A04-00026	REV -
DO NOT SCALE DRAWING			SCALE: 1:12	WEIGHT:	SHEET 2 OF 3

FINE | LINE

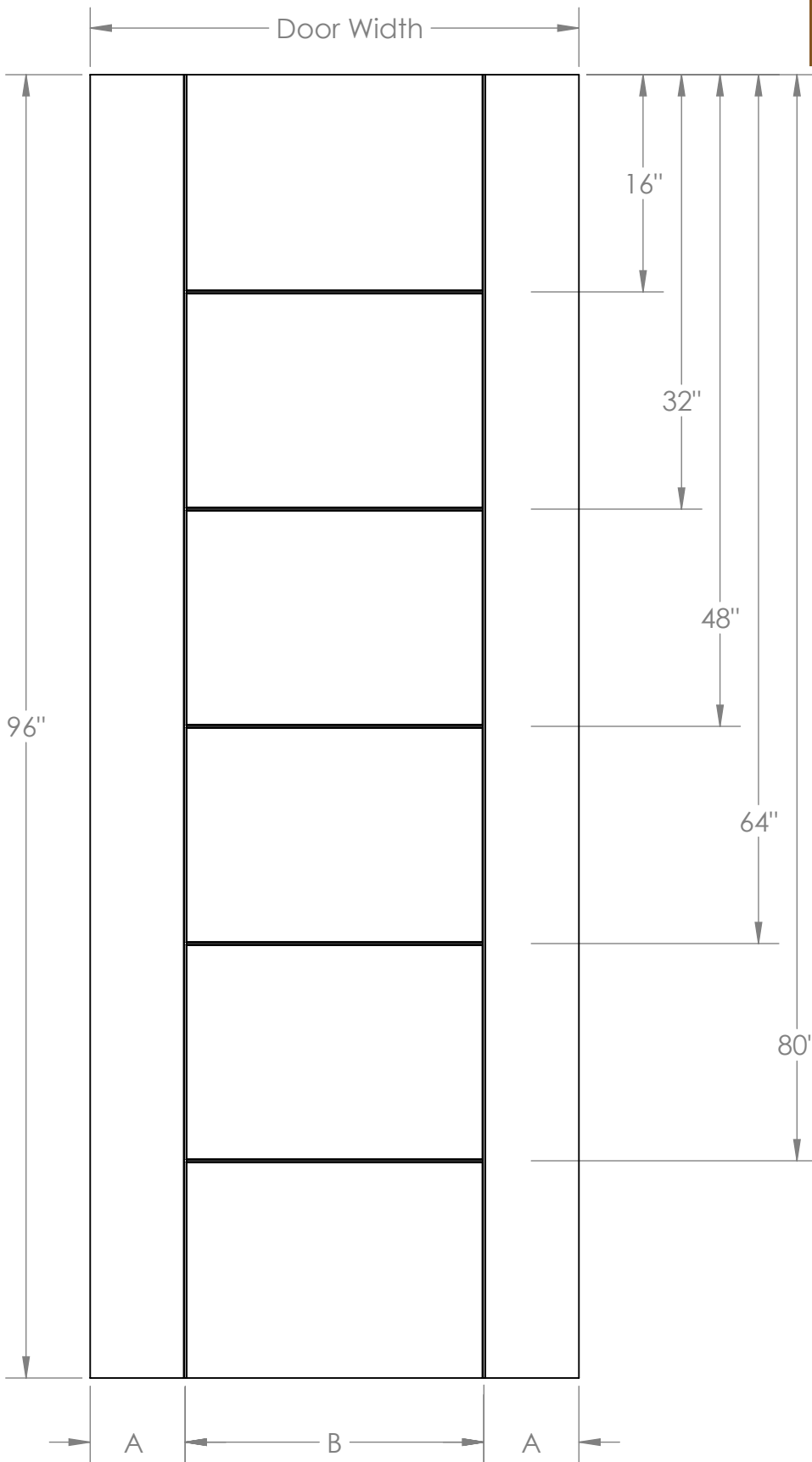

Robson 8'0"		
Door Width	A	B
3' 0"	7"	22"
2' 10"	7"	20"
2' 8"	7"	18"
2' 6"	6"	18"
2' 4"	6"	16"
2' 2"	6"	14"
2' 0"	5"	14"
1' 10"	5"	12"
1' 8"	5"	10"
1' 6"	5"	8"

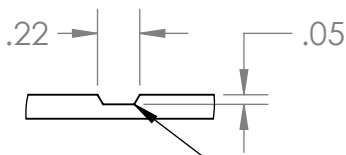

Rout Profile
SCALE 1 : 1

DRAWN	KC	07/28/15	MATERIAL	FINISH Primed
CHECKED	CB	10/26/15	Lynden Door, Inc. TITLE: Robson	
ENG APPR.	-	-		
MFG APPR.	-	-		
Q.A.	-	-		
<small>UNLESS OTHERWISE SPECIFIED: DIMENSIONS ARE IN: Inches TOLERANCES FRACTIONAL: ±1/16 ANGULAR: MACH ±2 BEND ± ONE PLACE DECIMAL: ± TWO PLACE DECIMAL: ±.02 THREE PLACE DECIMAL: ±</small>			SIZE A	DWG. NO. A04-00026
<small>DO NOT SCALE DRAWING</small>			SCALE: 1:12	WEIGHT:
			SHEET 3 OF 3	REV -

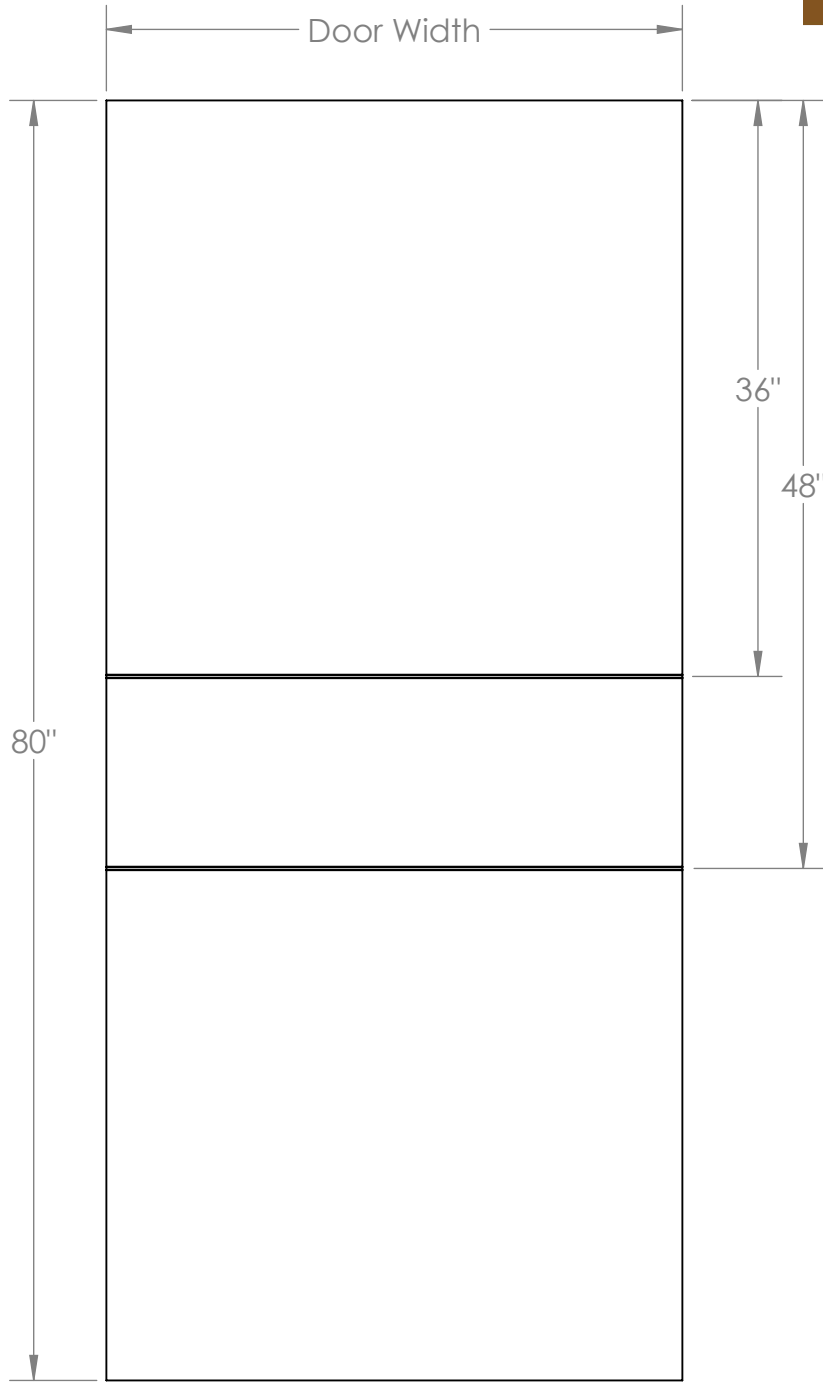

FINE LINE

Montlake 6'8" Door Width
3' 0"
2' 10"
2' 8"
2' 6"
2' 4"
2' 2"
2' 0"
1' 10"
1' 8"
1' 6"

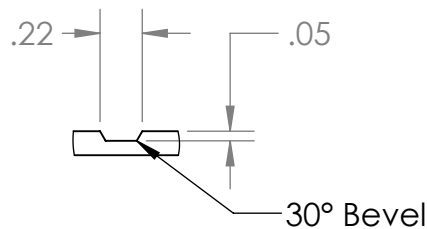

Rout Profile
SCALE 1 : 1

Notes:

1. Dimensions are to Centerline of Rout Profile
2. Line symmetry tolerance at $\pm 1/32"$

DRAWN	KC	07/28/15	MATERIAL	FINISH Primed	
CHECKED	CB	10/26/15	Lynden Door, Inc. <small>THE INFORMATION CONTAINED IN THIS DRAWING IS THE SOLE PROPERTY OF Lynden Door, Inc. ANY REPRODUCTION IN PART OR AS A WHOLE WITHOUT THE WRITTEN PERMISSION OF Lynden Door, Inc. IS PROHIBITED.</small>		
ENG APPR.	-	-			
MFG APPR.	-	-			
Q.A.	-	-			
<small>UNLESS OTHERWISE SPECIFIED: DIMENSIONS ARE IN: Inches TOLERANCES FRACTIONAL: $\pm 1/16$ ANGULAR: MACH ± 2 BEND ± 1 ONE PLACE DECIMAL: ± 1 TWO PLACE DECIMAL: $\pm .02$ THREE PLACE DECIMAL: $\pm .002$ </small>			TITLE: Montlake		
SIZE	A	DWG. NO.	A04-00027	REV	-
DO NOT SCALE DRAWING		SCALE:	1:12	WEIGHT:	
				SHEET	1 OF 3

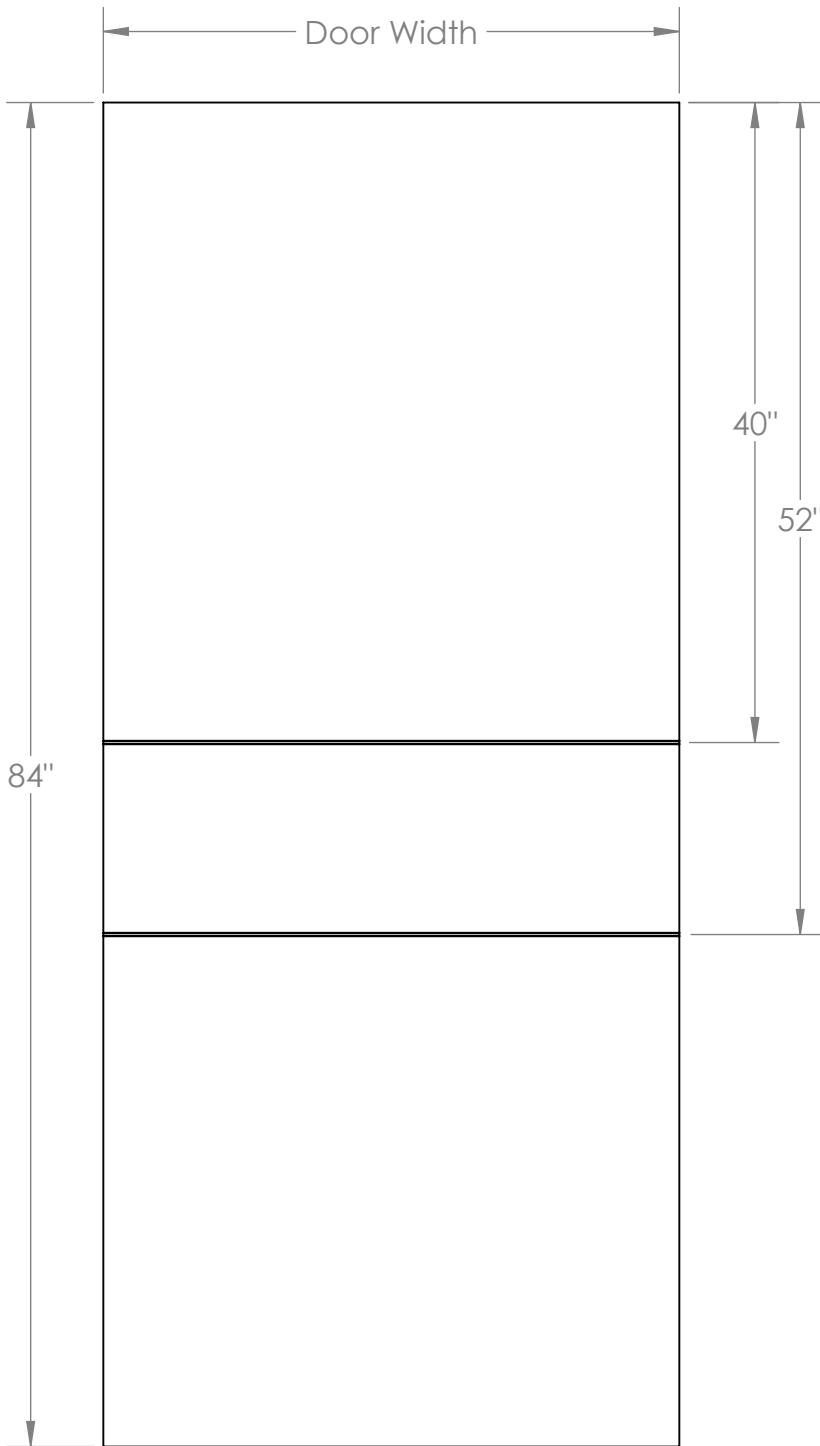

Montlake 7'0"	
Door Width	
3' 0"	
2' 10"	
2' 8"	
2' 6"	
2' 4"	
2' 2"	
2' 0"	
1' 10"	
1' 8"	
1' 6"	

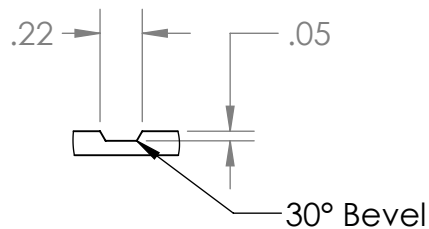

Rout Profile
SCALE 1 : 1

DRAWN	KC	07/28/15	MATERIAL	FINISH Primed
CHECKED	CB	10/26/15	Lynden Door, Inc.	
ENG APPR.	-	-		
MFG APPR.	-	-		
Q.A.	-	-		
UNLESS OTHERWISE SPECIFIED: DIMENSIONS ARE IN: Inches TOLERANCES FRACTIONAL: ±1/16 ANGULAR: MACH ±2 BEND ± ONE PLACE DECIMAL: ± TWO PLACE DECIMAL: ±.02 THREE PLACE DECIMAL: ±			THE INFORMATION CONTAINED IN THIS DRAWING IS THE SOLE PROPERTY OF Lynden Door, Inc. ANY REPRODUCTION IN PART OR AS A WHOLE WITHOUT THE WRITTEN PERMISSION OF Lynden Door, Inc. IS PROHIBITED.	
TITLE: Montlake			SIZE A	REV -
			DWG. NO. A04-00027	WEIGHT:
			SCALE: 1:12	SHEET 2 OF 3

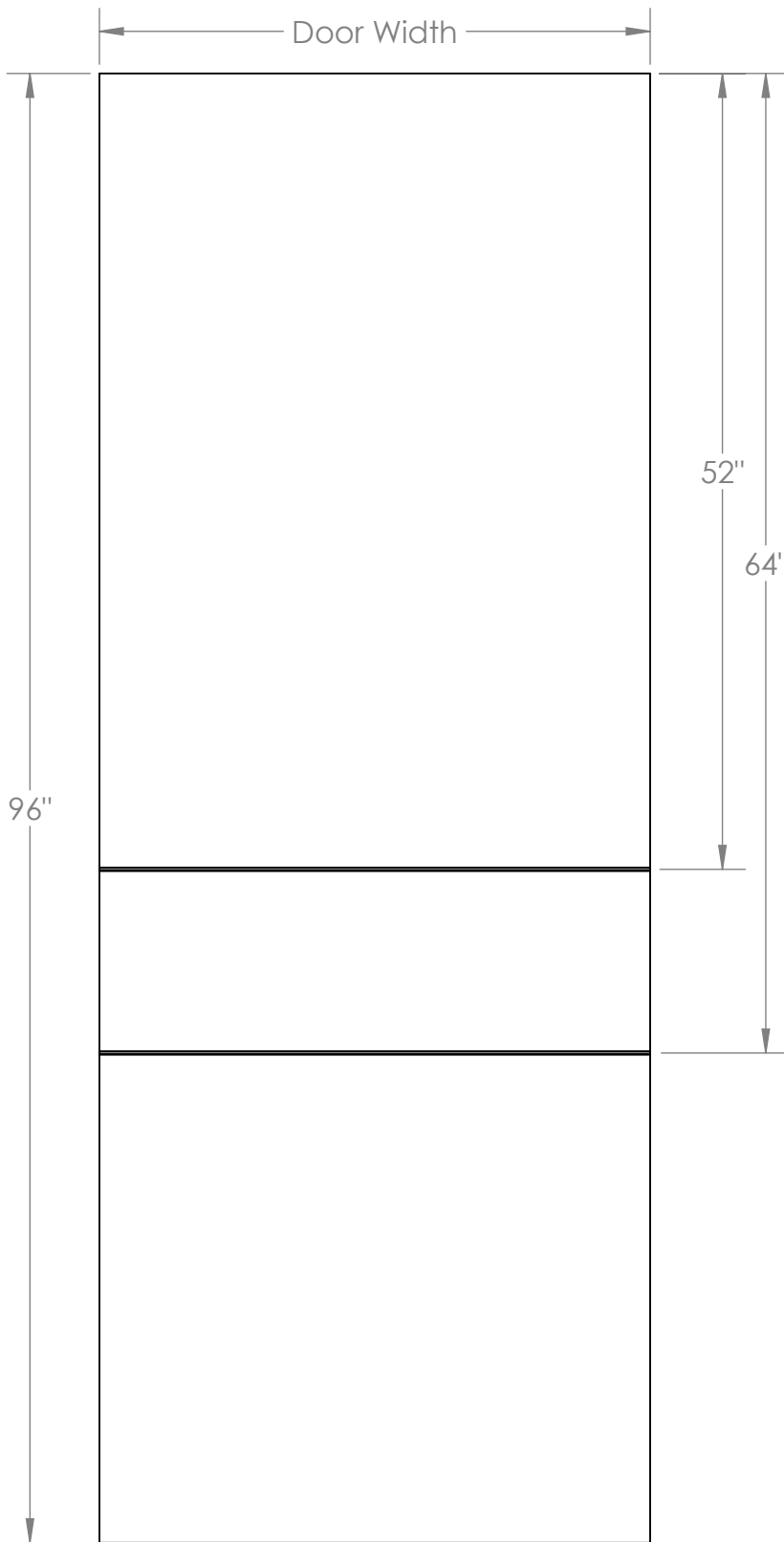

Montlake 8'0" Door Width
3' 0"
2' 10"
2' 8"
2' 6"
2' 4"
2' 2"
2' 0"
1' 10"
1' 8"
1' 6"

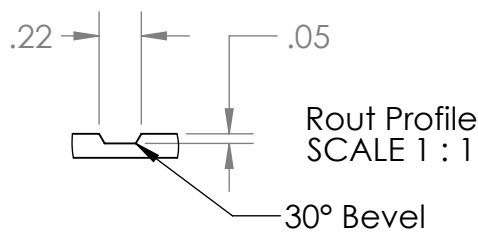

DRAWN	KC	07/28/15	MATERIAL	FINISH Primed	
CHECKED	CB	10/26/15	Lynden Door, Inc.		
ENG APPR.	-	-			
MFG APPR.	-	-			
Q.A.	-	-			
UNLESS OTHERWISE SPECIFIED: DIMENSIONS ARE IN: Inches TOLERANCES FRACTIONAL: ±1/16 ANGULAR: MACH ±2 BEND ± ONE PLACE DECIMAL: ± TWO PLACE DECIMAL: ±.02 THREE PLACE DECIMAL: ±			THE INFORMATION CONTAINED IN THIS DRAWING IS THE SOLE PROPERTY OF Lynden Door, Inc. ANY REPRODUCTION IN PART OR AS A WHOLE WITHOUT THE WRITTEN PERMISSION OF Lynden Door, Inc. IS PROHIBITED.		
TITLE: Montlake			SIZE A	DWG. NO. A04-00027	REV -
DO NOT SCALE DRAWING			SCALE: 1:12	WEIGHT:	SHEET 3 OF 3

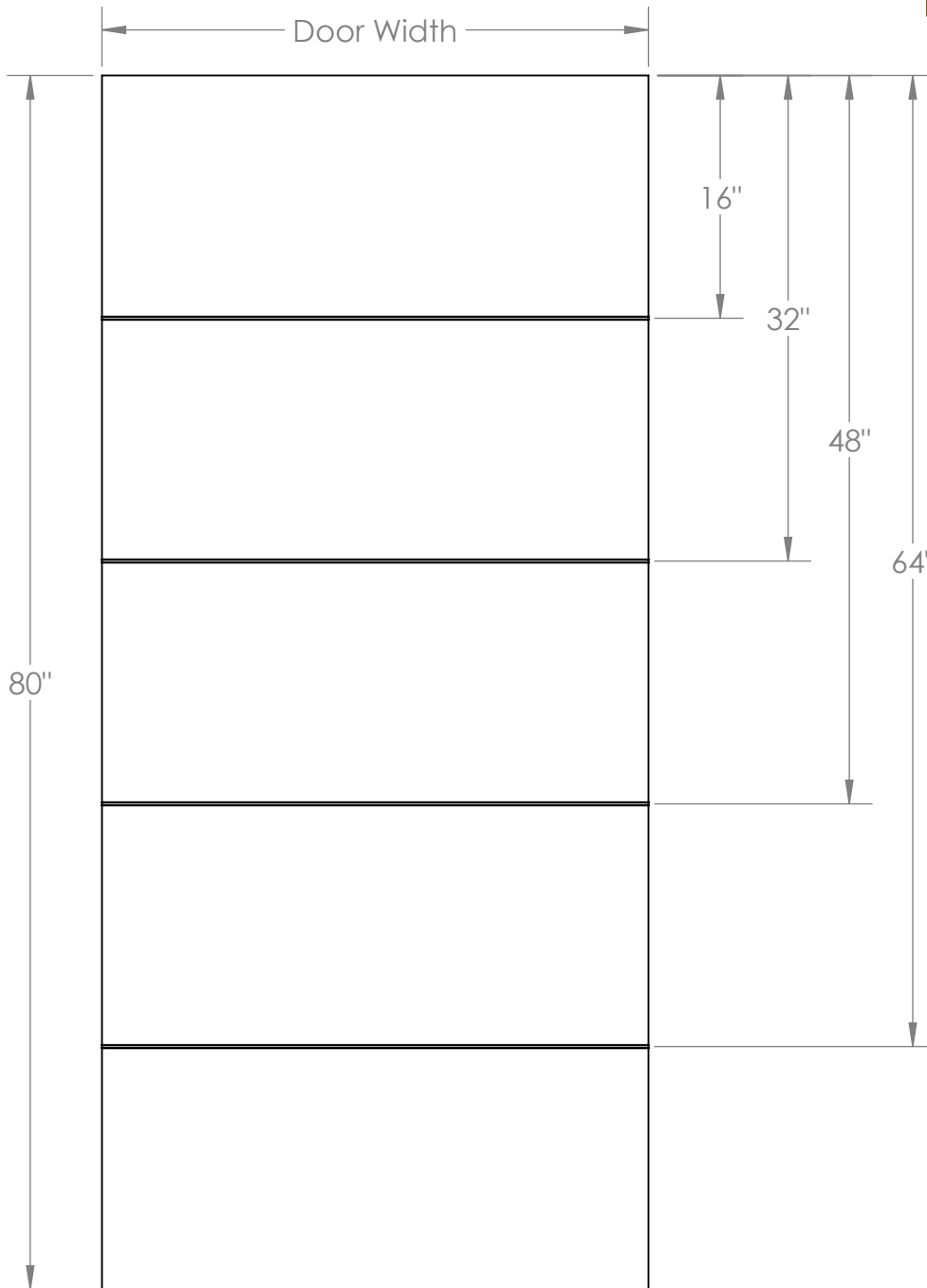

Denman 6'8" Door Width
3' 0"
2' 10"
2' 8"
2' 6"
2' 4"
2' 2"
2' 0"
1' 10"
1' 8"
1' 6"

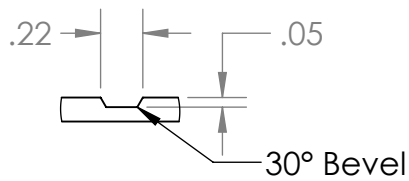

Rout Profile
SCALE 1 : 1

Notes:

1. Dimensions are to Centerline of Rout Profile
2. Line symmetry tolerance at $\pm 1/32"$

DRAWN KC	07/28/15	MATERIAL	FINISH Primed	
CHECKED CB	10/26/15	Lynden Door, Inc.		
ENG APPR. -	-			
MFG APPR. -	-			
Q.A. -	-			
UNLESS OTHERWISE SPECIFIED: DIMENSIONS ARE IN: Inches TOLERANCES FRACTIONAL: $\pm 1/16$ ANGULAR: MACH ± 2 BEND ± 1 ONE PLACE DECIMAL: ± 1 TWO PLACE DECIMAL: $\pm .02$ THREE PLACE DECIMAL: $\pm .002$		THE INFORMATION CONTAINED IN THIS DRAWING IS THE SOLE PROPERTY OF Lynden Door, Inc. ANY REPRODUCTION IN PART OR AS A WHOLE WITHOUT THE WRITTEN PERMISSION OF Lynden Door, Inc. IS PROHIBITED.		
TITLE: Denman		SIZE A	DWG. NO. A04-00028	REV -
DO NOT SCALE DRAWING		SCALE: 1:12	WEIGHT:	SHEET 1 OF 3

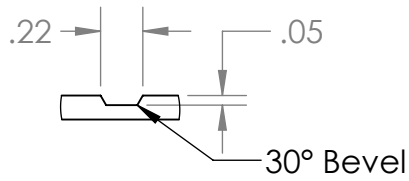
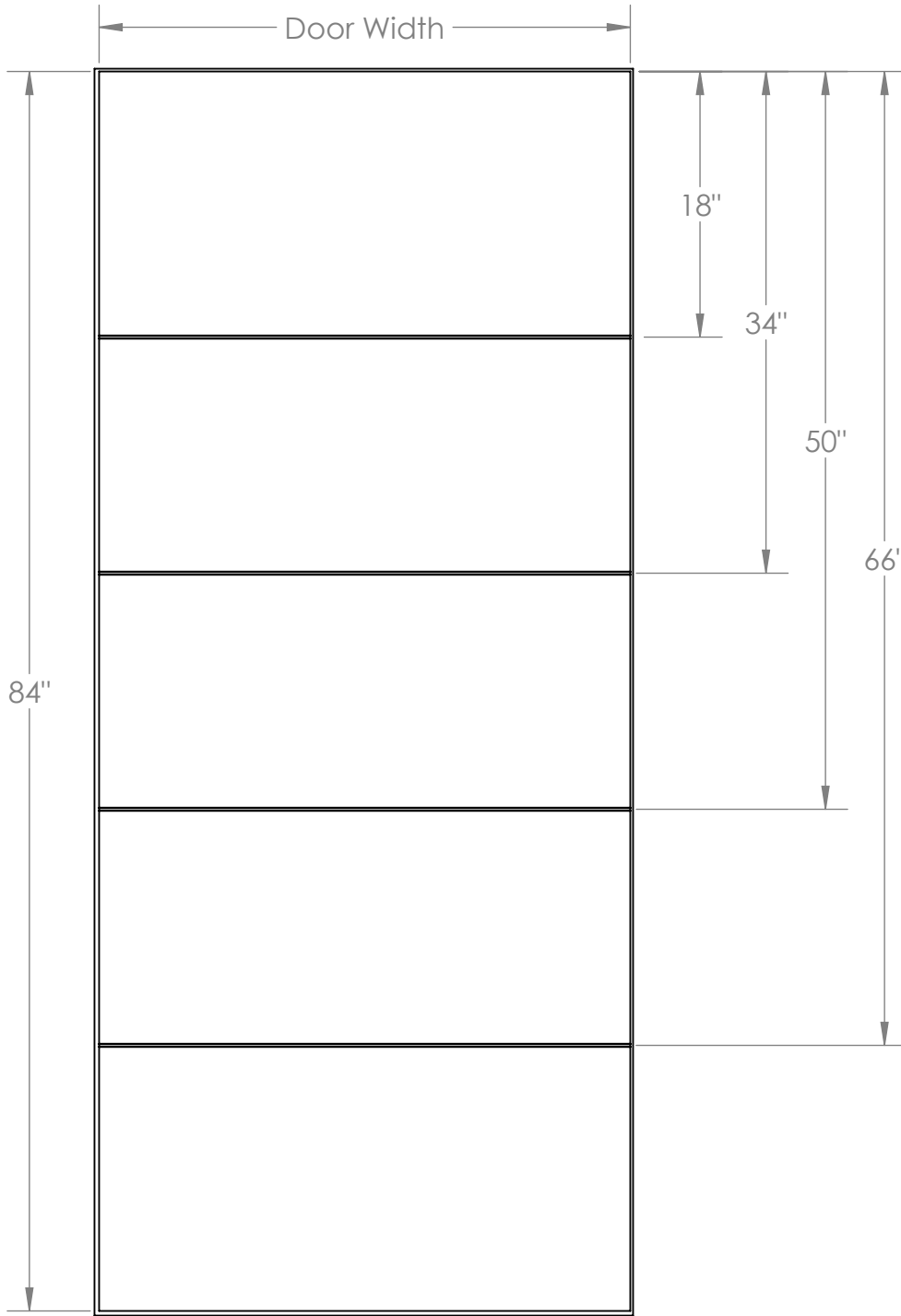

Rout Profile
SCALE 1 : 1

Denman 7'0" Door Width
3' 0"
2' 10"
2' 8"
2' 6"
2' 4"
2' 2"
2' 0"
1' 10"
1' 8"
1' 6"

DRAWN KC	07/28/15	MATERIAL	FINISH Primed	
CHECKED CB	10/26/15	<h1>Lynden Door, Inc.</h1>		
ENG APPR. -	-			
MFG APPR. -	-			
Q.A. -	-			
<small>UNLESS OTHERWISE SPECIFIED: DIMENSIONS ARE IN: Inches TOLERANCES FRACTIONAL: ±1/16 ANGULAR: MACH ±2 BEND ± ONE PLACE DECIMAL: ± TWO PLACE DECIMAL: ±.02 THREE PLACE DECIMAL: ±</small>		<small>THE INFORMATION CONTAINED IN THIS DRAWING IS THE SOLE PROPERTY OF Lynden Door, Inc. ANY REPRODUCTION IN PART OR AS A WHOLE WITHOUT THE WRITTEN PERMISSION OF Lynden Door, Inc. IS PROHIBITED.</small>		
TITLE: Denman		SIZE A	DWG. NO. A04-00028	REV -
DO NOT SCALE DRAWING		SCALE: 1:12	WEIGHT:	SHEET 2 OF 3

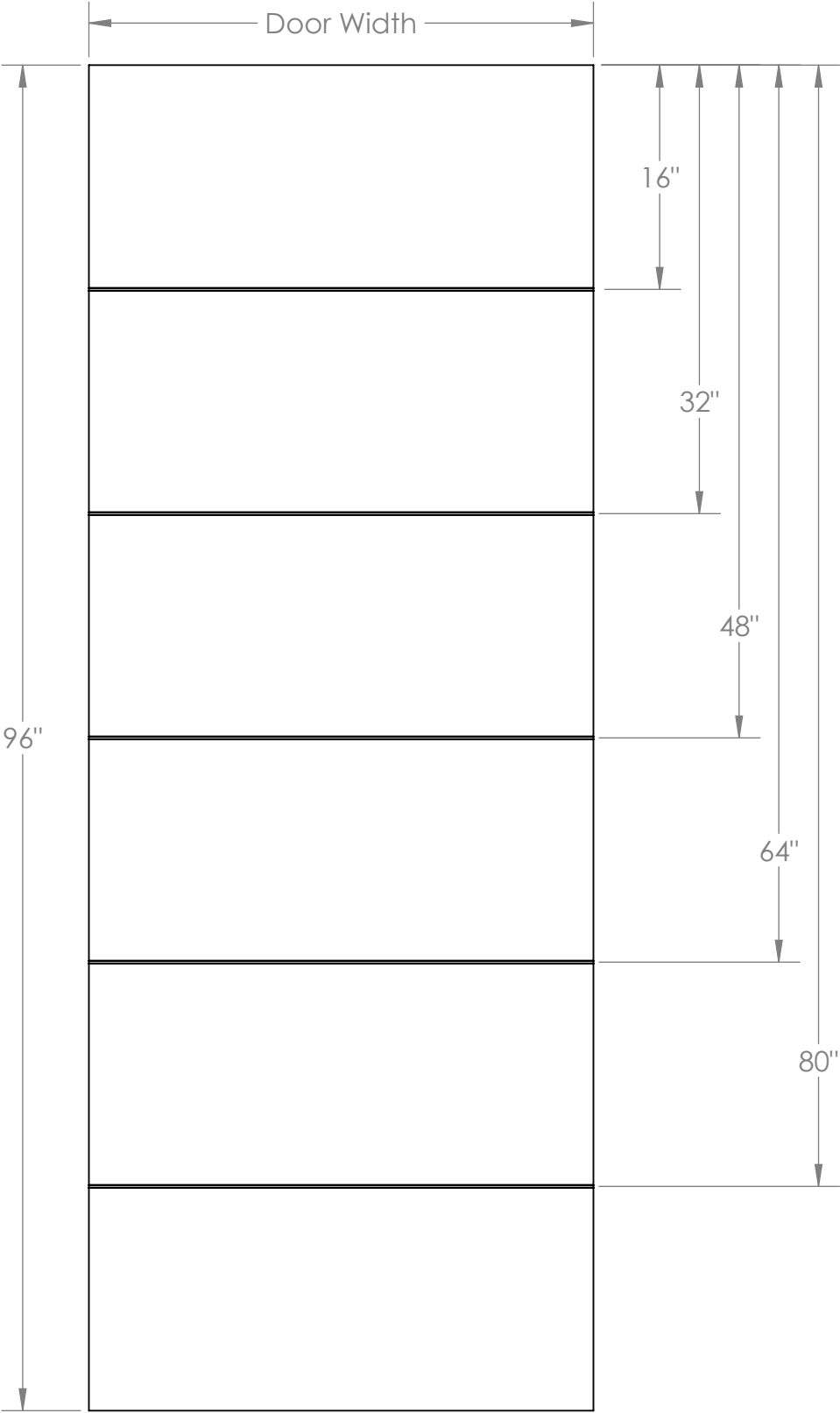

Denman 8'0" Door Width	
3' 0"	
2' 10"	
2' 8"	
2' 6"	
2' 4"	
2' 2"	
2' 0"	
1' 10"	
1' 8"	
1' 6"	

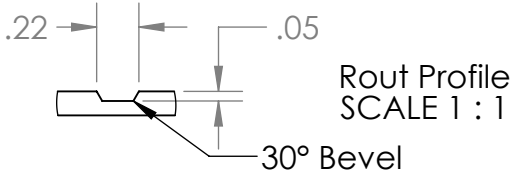

DRAWN: KC	07/28/15	MATERIAL:	FINISH: Primed
CHECKED: CB	10/26/15	<h1>Lynden Door, Inc.</h1>	
ENG APPR: -	-		
MFG APPR: -	-		
Q.A.: -	-		
<small>UNLESS OTHERWISE SPECIFIED: DIMENSIONS ARE IN: Inches TOLERANCES FRACTIONAL: ±1/16 ANGULAR: MACH ±2 BEND ±</small>		<small>THE INFORMATION CONTAINED IN THIS DRAWING IS THE SOLE PROPERTY OF Lynden Door, Inc. ANY REPRODUCTION IN PART OR AS A WHOLE WITHOUT THE WRITTEN PERMISSION OF Lynden Door, Inc. IS PROHIBITED.</small>	
TITLE: Denman		SIZE: A	REV: -
DWG. NO. A04-00028		SCALE: 1:12	WEIGHT:
DO NOT SCALE DRAWING		SHEET 3 OF 3	

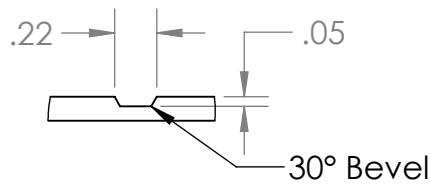
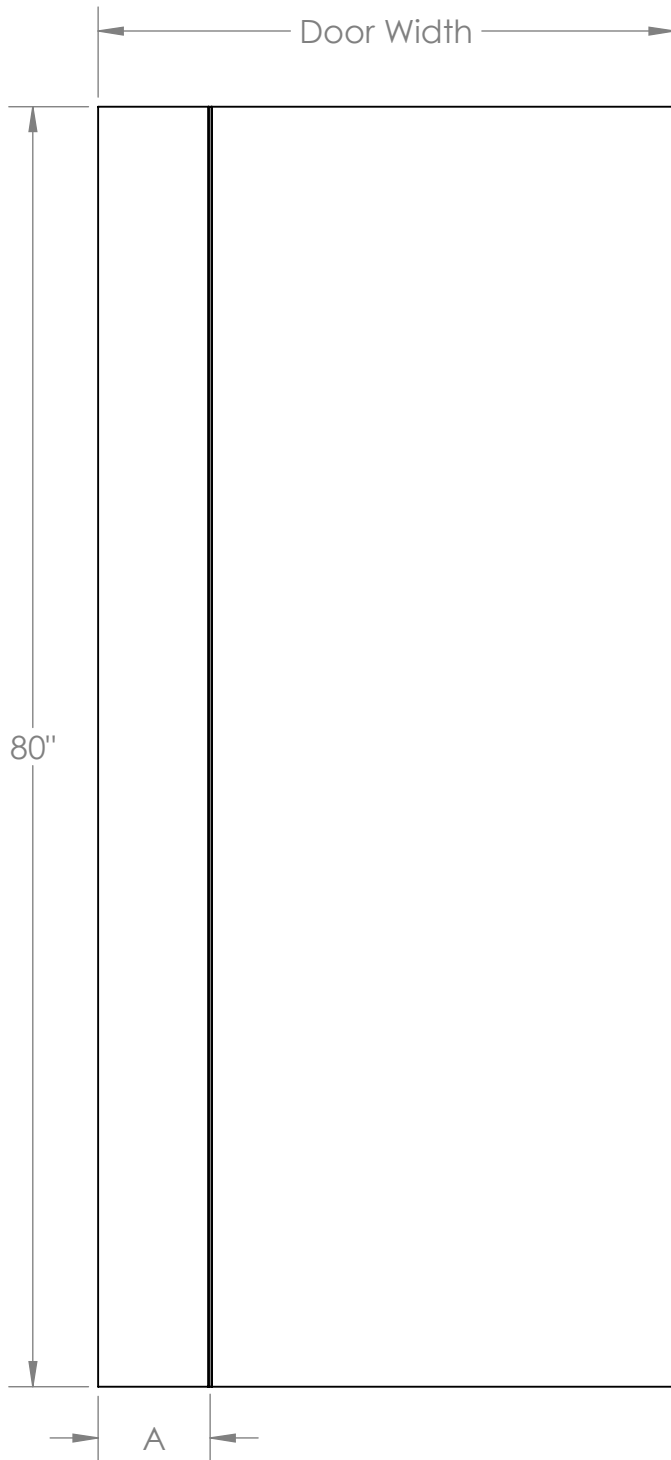

Rout Profile
SCALE 1 : 1

Laurelhurst 6'8"	
Door Width	A
3' 0"	7"
2' 10"	7"
2' 8"	7"
2' 6"	6"
2' 4"	6"
2' 2"	6"
2' 0"	5"
1' 10"	5"
1' 8"	5"
1' 6"	5"

Notes:

1. Dimensions are to Centerline of Rout Profile
2. Line symmetry tolerance at $\pm 1/32"$

DRAWN KC	07/28/15	MATERIAL	FINISH Primed
CHECKED CB	10/26/15	<h2 style="text-align: center;">Lynden Door, Inc.</h2>	
ENG APPR. -	-		
MFG APPR. -	-		
Q.A. -	-		
<small>UNLESS OTHERWISE SPECIFIED: DIMENSIONS ARE IN: Inches TOLERANCES FRACTIONAL: $\pm 1/16$ ANGULAR: MACH ± 2 BEND ± 1 ONE PLACE DECIMAL: ± 1 TWO PLACE DECIMAL: $\pm .02$ THREE PLACE DECIMAL: $\pm .005$</small>		<small>THE INFORMATION CONTAINED IN THIS DRAWING IS THE SOLE PROPERTY OF Lynden Door, Inc. ANY REPRODUCTION IN PART OR AS A WHOLE WITHOUT THE WRITTEN PERMISSION OF Lynden Door, Inc. IS PROHIBITED.</small>	
TITLE: Laurelhurst		SIZE A	DWG. NO. A04-00023
		SCALE: 1:12	WEIGHT:
		REV -	
		SHEET 1 OF 3	

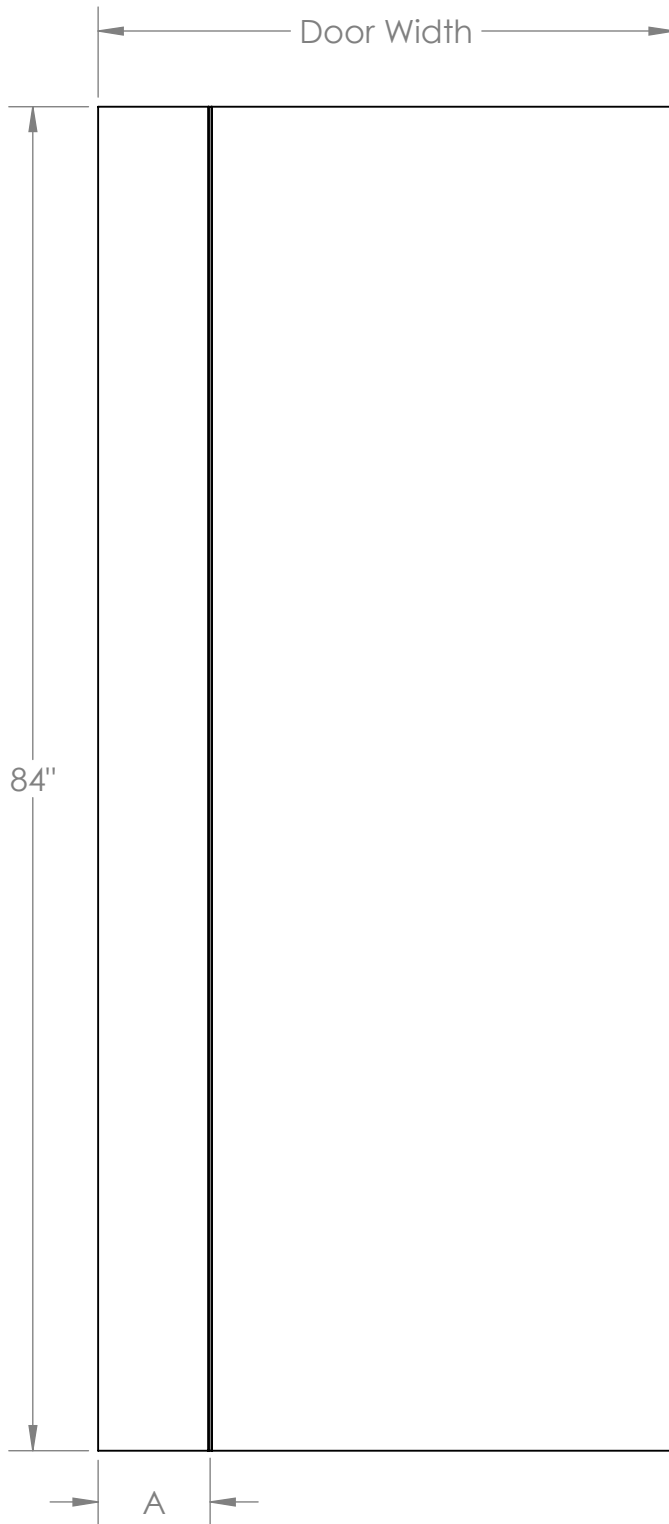

Laurelhurst 7'0"	
Door Width	A
3' 0"	7"
2' 10"	7"
2' 8"	7"
2' 6"	6"
2' 4"	6"
2' 2"	6"
2' 0"	5"
1' 10"	5"
1' 8"	5"
1' 6"	5"

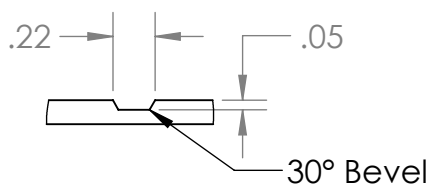

Rout Profile
SCALE 1 : 1

DRAWN	KC	07/28/15	MATERIAL	FINISH Primed	
CHECKED	CB	10/26/15	Lynden Door, Inc. <small>THE INFORMATION CONTAINED IN THIS DRAWING IS THE SOLE PROPERTY OF Lynden Door, Inc. ANY REPRODUCTION IN PART OR AS A WHOLE WITHOUT THE WRITTEN PERMISSION OF Lynden Door, Inc. IS PROHIBITED.</small>		
ENG APPR.	-	-			
MFG APPR.	-	-			
Q.A.	-	-			
<small>UNLESS OTHERWISE SPECIFIED: DIMENSIONS ARE IN: Inches TOLERANCES FRACTIONAL: ±1/16 ANGULAR: MACH ±2 BEND ± ONE PLACE DECIMAL: ± TWO PLACE DECIMAL: ±.02 THREE PLACE DECIMAL: ±</small>					
TITLE: Laurelhurst					
SIZE	A	DWG. NO.	A04-00023	REV	-
		SCALE:	1:12	WEIGHT:	
				SHEET	2 OF 3

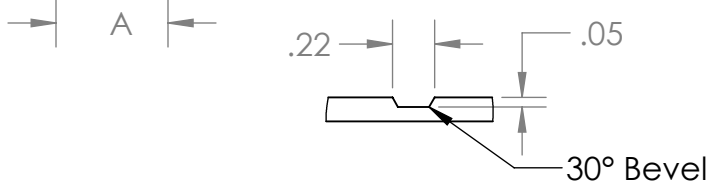
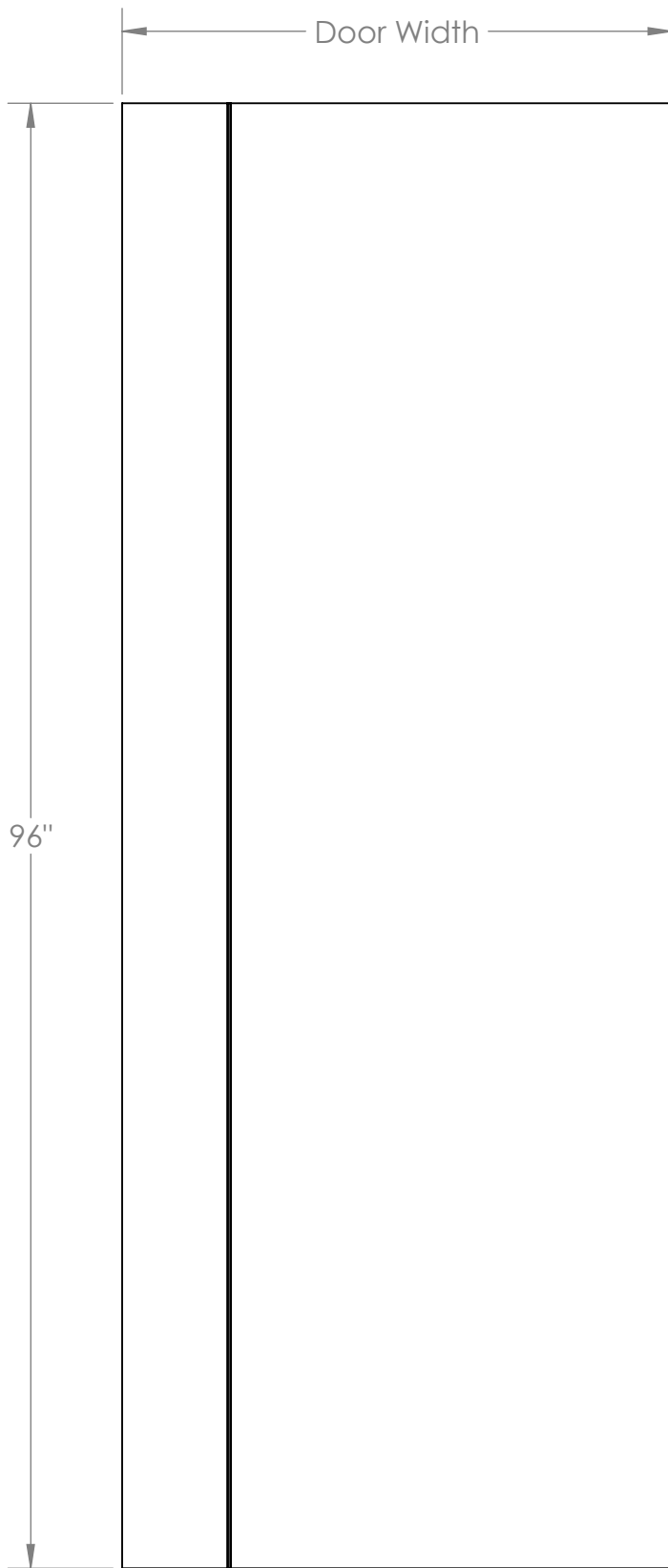

Rout Profile
SCALE 1 : 1

Laurelhurst 8'0"	
Door Width	A
3' 0"	7"
2' 10"	7"
2' 8"	7"
2' 6"	6"
2' 4"	6"
2' 2"	6"
2' 0"	5"
1' 10"	5"
1' 8"	5"
1' 6"	5"

DRAWN	KC	07/28/15	MATERIAL	FINISH Primed	
CHECKED	CB	10/26/15	Lynden Door, Inc. <small>THE INFORMATION CONTAINED IN THIS DRAWING IS THE SOLE PROPERTY OF Lynden Door, Inc. ANY REPRODUCTION IN PART OR AS A WHOLE WITHOUT THE WRITTEN PERMISSION OF Lynden Door, Inc. IS PROHIBITED.</small>		
ENG APPR.	-	-			
MFG APPR.	-	-			
Q.A.	-	-			
<small>UNLESS OTHERWISE SPECIFIED: DIMENSIONS ARE IN: Inches TOLERANCES FRACTIONAL: ±1/16 ANGULAR: MACH ±2 BEND ± ONE PLACE DECIMAL: ± TWO PLACE DECIMAL: ±.02 THREE PLACE DECIMAL: ±</small>			TITLE: Laurelhurst		
SIZE	A	DWG. NO.	A04-00023	REV	-
		SCALE:	1:12	WEIGHT:	
				SHEET	3 OF 3

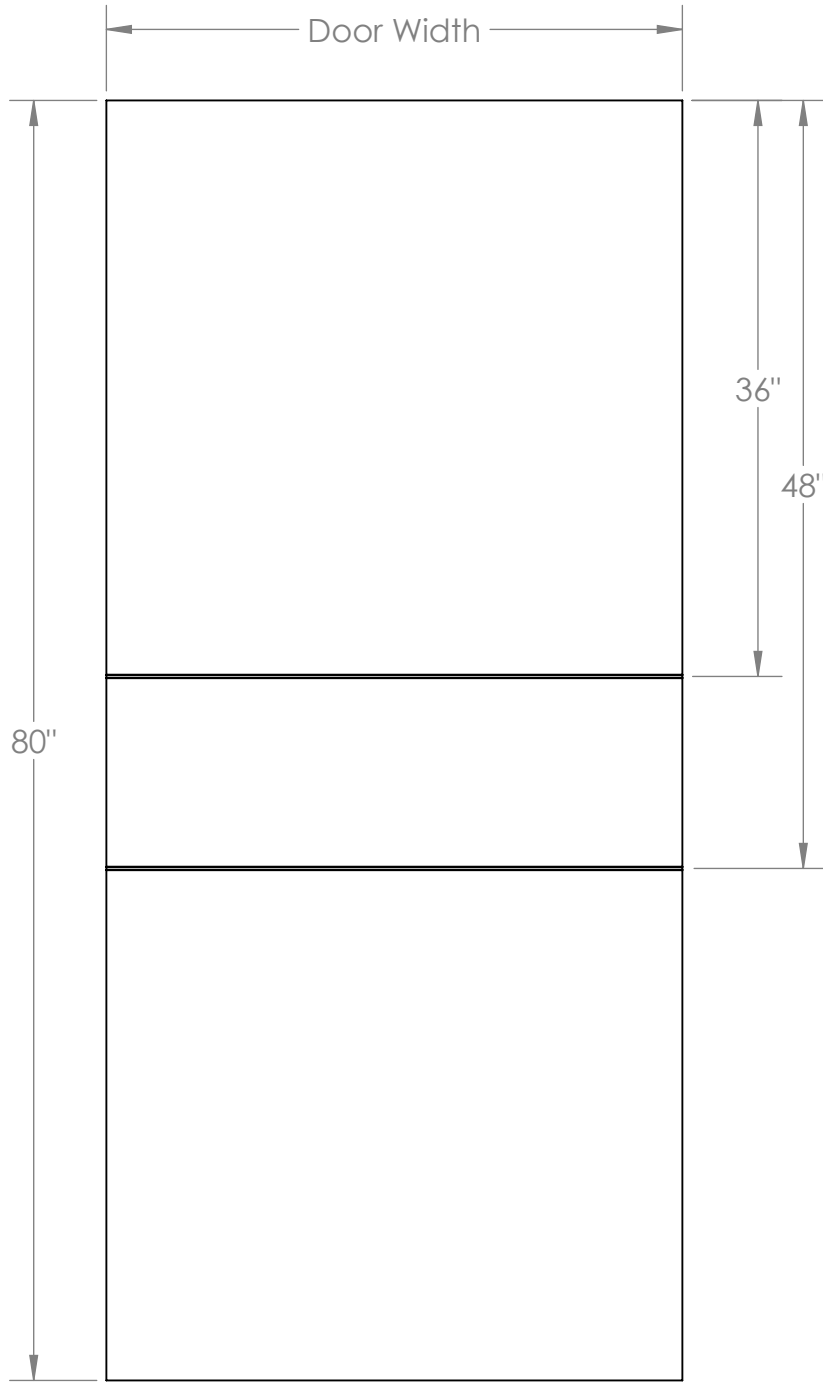

Montlake 6'8"
Door Width
3' 0"
2' 10"
2' 8"
2' 6"
2' 4"
2' 2"
2' 0"
1' 10"
1' 8"
1' 6"

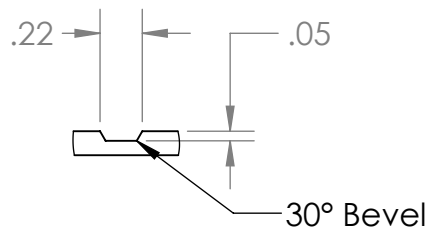

Rout Profile
SCALE 1 : 1

Notes:

1. Dimensions are to Centerline of Rout Profile
2. Line symmetry tolerance at $\pm 1/32"$

DRAWN	KC	07/28/15	MATERIAL	FINISH Primed	
CHECKED	CB	10/26/15	<h2 style="text-align: center;">Lynden Door, Inc.</h2>		
ENG APPR.	-	-			
MFG APPR.	-	-			
Q.A.	-	-			
<small>UNLESS OTHERWISE SPECIFIED: DIMENSIONS ARE IN: Inches TOLERANCES FRACTIONAL: $\pm 1/16$ ANGULAR: MACH ± 2 BEND ± 1 ONE PLACE DECIMAL: ± 1 TWO PLACE DECIMAL: $\pm .02$ THREE PLACE DECIMAL: $\pm .002$</small>			<small>THE INFORMATION CONTAINED IN THIS DRAWING IS THE SOLE PROPERTY OF Lynden Door, Inc. ANY REPRODUCTION IN PART OR AS A WHOLE WITHOUT THE WRITTEN PERMISSION OF Lynden Door, Inc. IS PROHIBITED.</small>		
TITLE:			Montlake		
SIZE	A	DWG. NO.	A04-00027	REV	-
SCALE: 1:12		WEIGHT:		SHEET 1 OF 3	

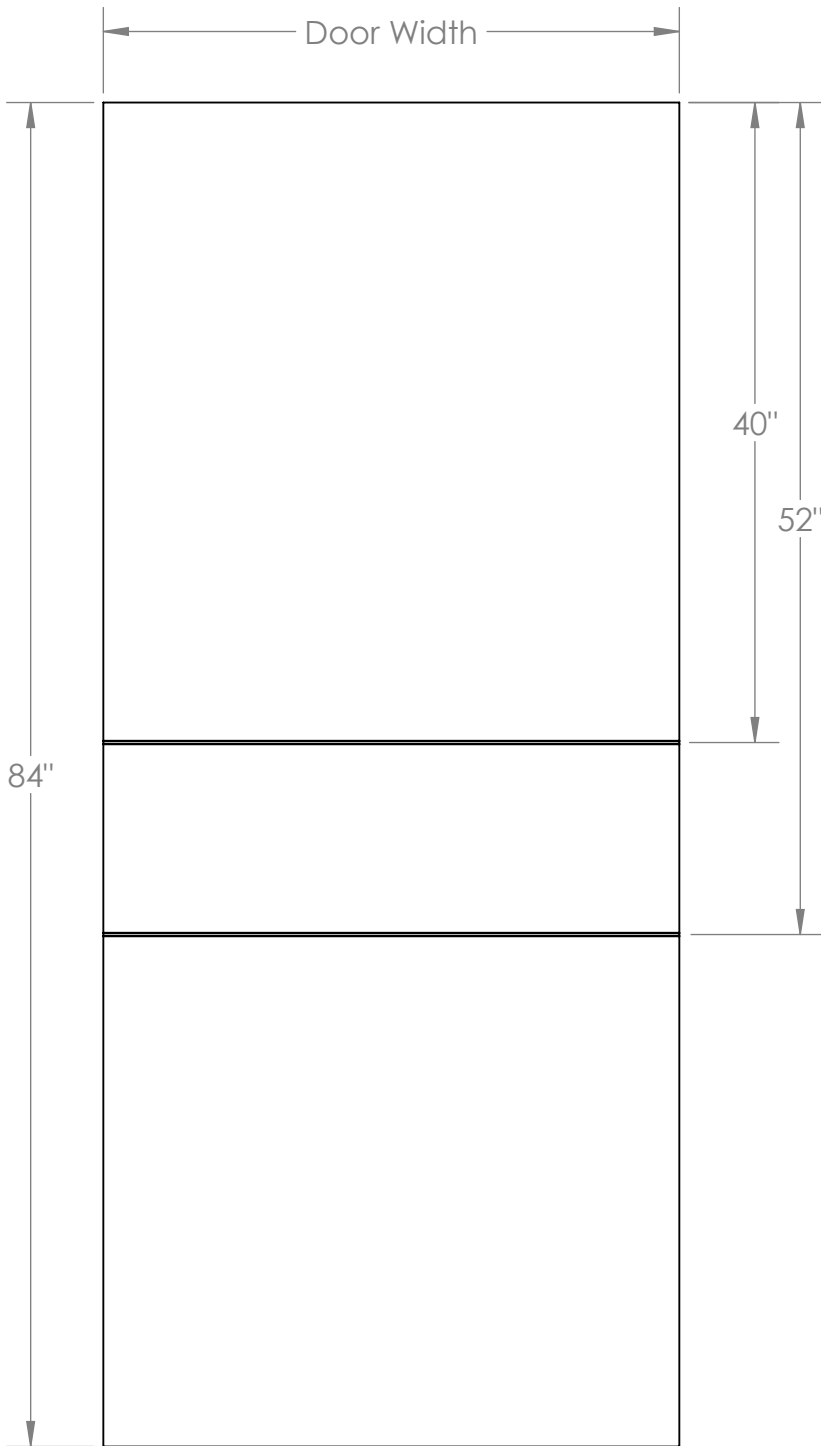

Montlake 7'0" Door Width
3' 0"
2' 10"
2' 8"
2' 6"
2' 4"
2' 2"
2' 0"
1' 10"
1' 8"
1' 6"

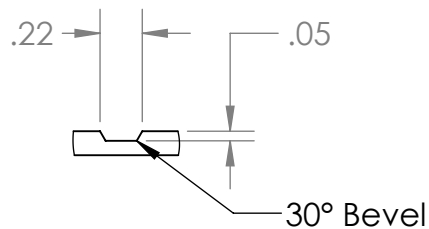

Rout Profile
SCALE 1 : 1

DRAWN	KC	07/28/15	MATERIAL	FINISH Primed
CHECKED	CB	10/26/15	Lynden Door, Inc.	
ENG APPR.	-	-		
MFG APPR.	-	-		
Q.A.	-	-		
UNLESS OTHERWISE SPECIFIED: DIMENSIONS ARE IN: Inches TOLERANCES FRACTIONAL: ±1/16 ANGULAR: MACH ±2 BEND ± ONE PLACE DECIMAL: ± TWO PLACE DECIMAL: ±.02 THREE PLACE DECIMAL: ±			THE INFORMATION CONTAINED IN THIS DRAWING IS THE SOLE PROPERTY OF Lynden Door, Inc. ANY REPRODUCTION IN PART OR AS A WHOLE WITHOUT THE WRITTEN PERMISSION OF Lynden Door, Inc. IS PROHIBITED.	
TITLE: Montlake			SIZE A	REV -
DWG. NO. A04-00027			SCALE: 1:12	WEIGHT:
			SHEET 2 OF 3	

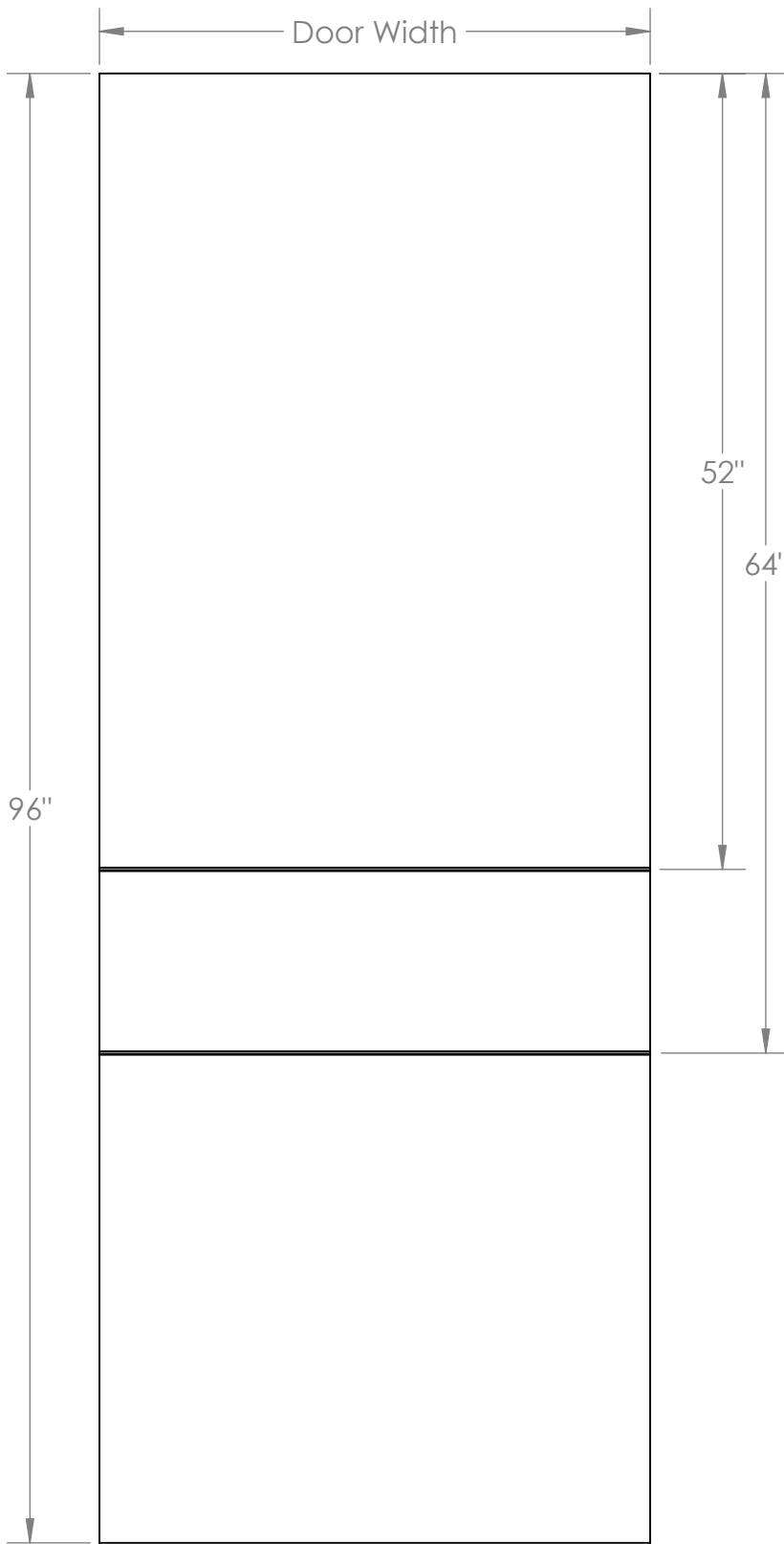

Montlake 8'0" Door Width
3' 0"
2' 10"
2' 8"
2' 6"
2' 4"
2' 2"
2' 0"
1' 10"
1' 8"
1' 6"

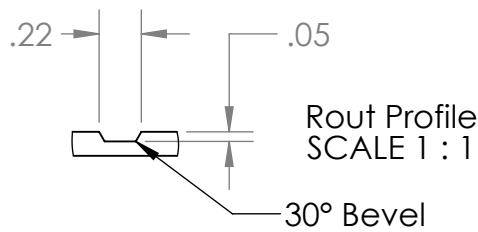

DRAWN	KC	07/28/15	MATERIAL	FINISH Primed
CHECKED	CB	10/26/15	Lynden Door, Inc.	
ENG APPR.	-	-		
MFG APPR.	-	-		
Q.A.	-	-		
UNLESS OTHERWISE SPECIFIED: DIMENSIONS ARE IN: Inches TOLERANCES FRACTIONAL: ±1/16 ANGULAR: MACH ±2 BEND ± ONE PLACE DECIMAL: ± TWO PLACE DECIMAL: ±.02 THREE PLACE DECIMAL: ±			THE INFORMATION CONTAINED IN THIS DRAWING IS THE SOLE PROPERTY OF Lynden Door, Inc. ANY REPRODUCTION IN PART OR AS A WHOLE WITHOUT THE WRITTEN PERMISSION OF Lynden Door, Inc. IS PROHIBITED.	
			TITLE: Montlake	
SIZE	A	DWG. NO. A04-00027	REV -	
		SCALE: 1:12	WEIGHT:	SHEET 3 OF 3

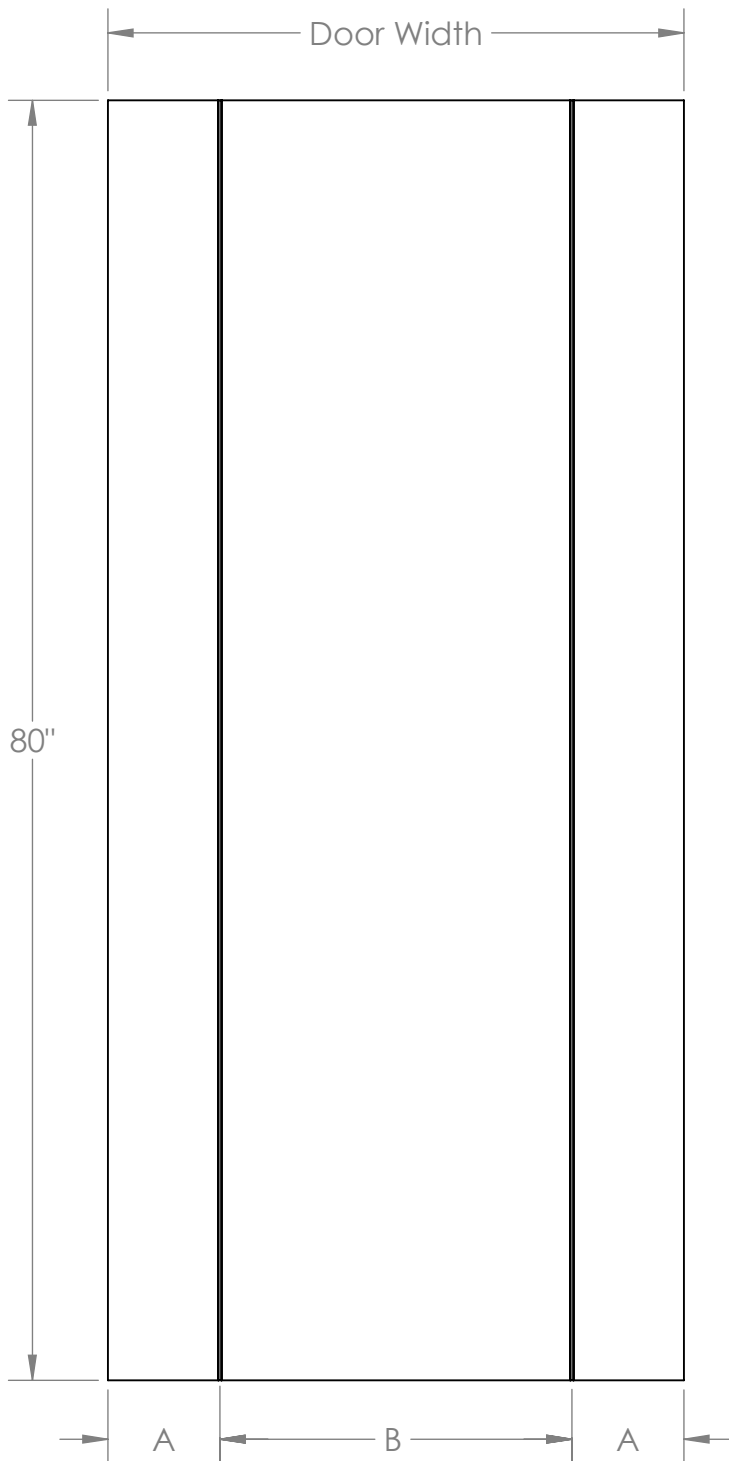

Parkrose 6'8"		
Door Width	A	B
3' 0"	7"	22"
2' 10"	7"	20"
2' 8"	7"	18"
2' 6"	6"	18"
2' 4"	6"	16"
2' 2"	6"	14"
2' 0"	5"	14"
1' 10"	5"	12"
1' 8"	5"	10"
1' 6"	5"	8"

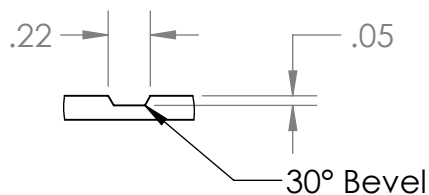

Rout Profile
SCALE 1 : 1

Notes:

1. Dimensions are to Centerline of Rout Profile
2. Line symmetry tolerance at $\pm 1/32"$

DRAWN	KC	07/28/15	MATERIAL	FINISH Primed
CHECKED	CB	10/26/15	Lynden Door, Inc. <small>THE INFORMATION CONTAINED IN THIS DRAWING IS THE SOLE PROPERTY OF Lynden Door, Inc. ANY REPRODUCTION IN PART OR AS A WHOLE WITHOUT THE WRITTEN PERMISSION OF Lynden Door, Inc. IS PROHIBITED.</small>	
ENG APPR.	-	-		
MFG APPR.	-	-		
Q.A.	-	-		
<small>UNLESS OTHERWISE SPECIFIED: DIMENSIONS ARE IN: Inches TOLERANCES FRACTIONAL: $\pm 1/16$ ANGULAR: MACH ± 2 BEND ± 1 ONE PLACE DECIMAL: ± 1 TWO PLACE DECIMAL: $\pm .02$ THREE PLACE DECIMAL: $\pm .002$</small>			TITLE: Parkrose	
SIZE	A	DWG. NO. A04-00024	REV -	
DO NOT SCALE DRAWING		SCALE: 1:12	WEIGHT:	SHEET 1 OF 3

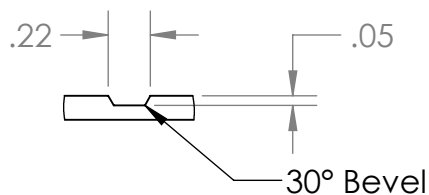
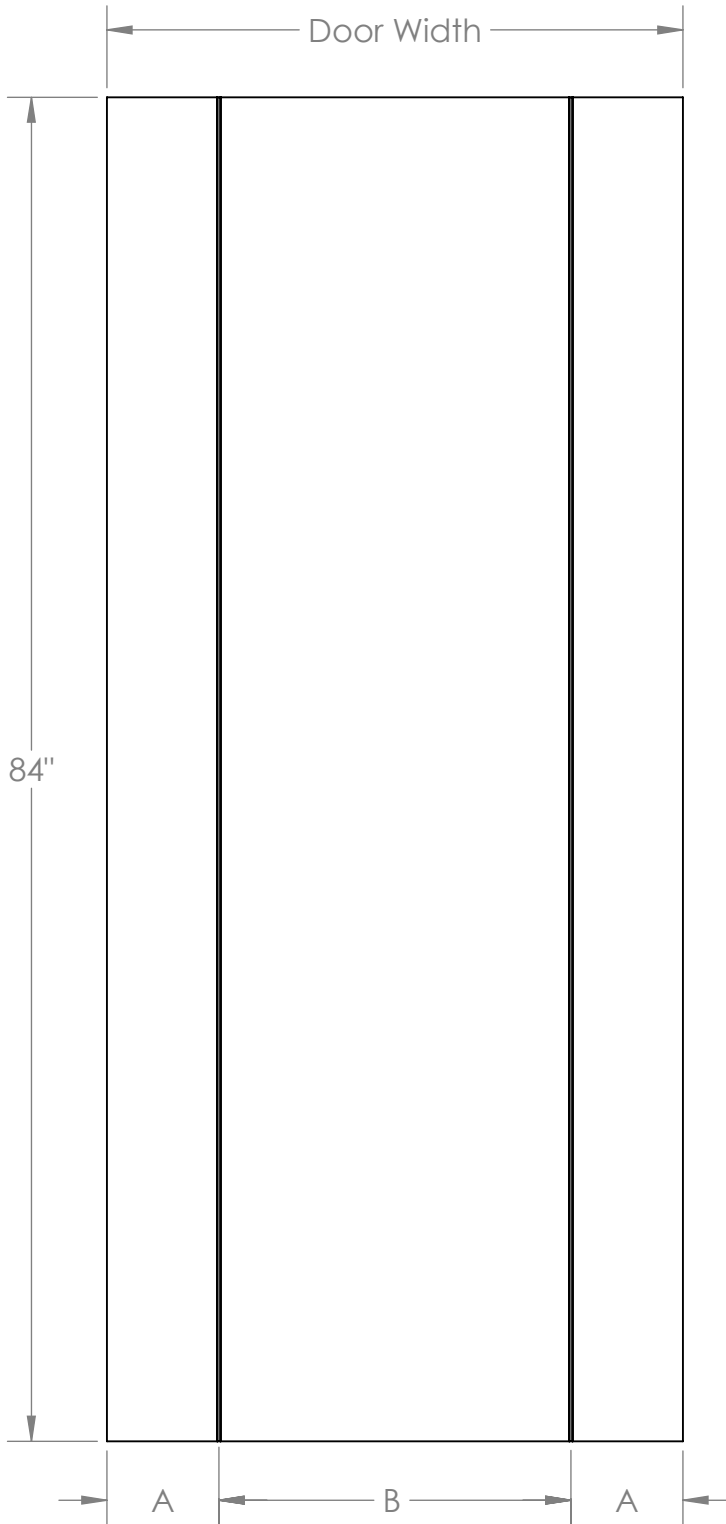

Rout Profile
SCALE 1 : 1

Parkrose 7'0"		
Door Width	A	B
3' 0"	7"	22"
2' 10"	7"	20"
2' 8"	7"	18"
2' 6"	6"	18"
2' 4"	6"	16"
2' 2"	6"	14"
2' 0"	5"	14"
1' 10"	5"	12"
1' 8"	5"	10"
1' 6"	5"	8"

DRAWN	KC	07/28/15	MATERIAL	FINISH Primed	
CHECKED	CB	10/26/15	Lynden Door, Inc. <small>THE INFORMATION CONTAINED IN THIS DRAWING IS THE SOLE PROPERTY OF Lynden Door, Inc. ANY REPRODUCTION IN PART OR AS A WHOLE WITHOUT THE WRITTEN PERMISSION OF Lynden Door, Inc. IS PROHIBITED.</small>		
ENG APPR.	-	-			
MFG APPR.	-	-			
Q.A.	-	-			
<small>UNLESS OTHERWISE SPECIFIED: DIMENSIONS ARE IN: Inches TOLERANCES FRACTIONAL: ±1/16 ANGULAR: MACH ±2 BEND ± ONE PLACE DECIMAL: ± TWO PLACE DECIMAL: ±.02 THREE PLACE DECIMAL: ±</small>			TITLE: Parkrose		
SIZE	A	DWG. NO.	A04-00024	REV	-
DO NOT SCALE DRAWING		SCALE:	1:12	WEIGHT:	
				SHEET	2 OF 3

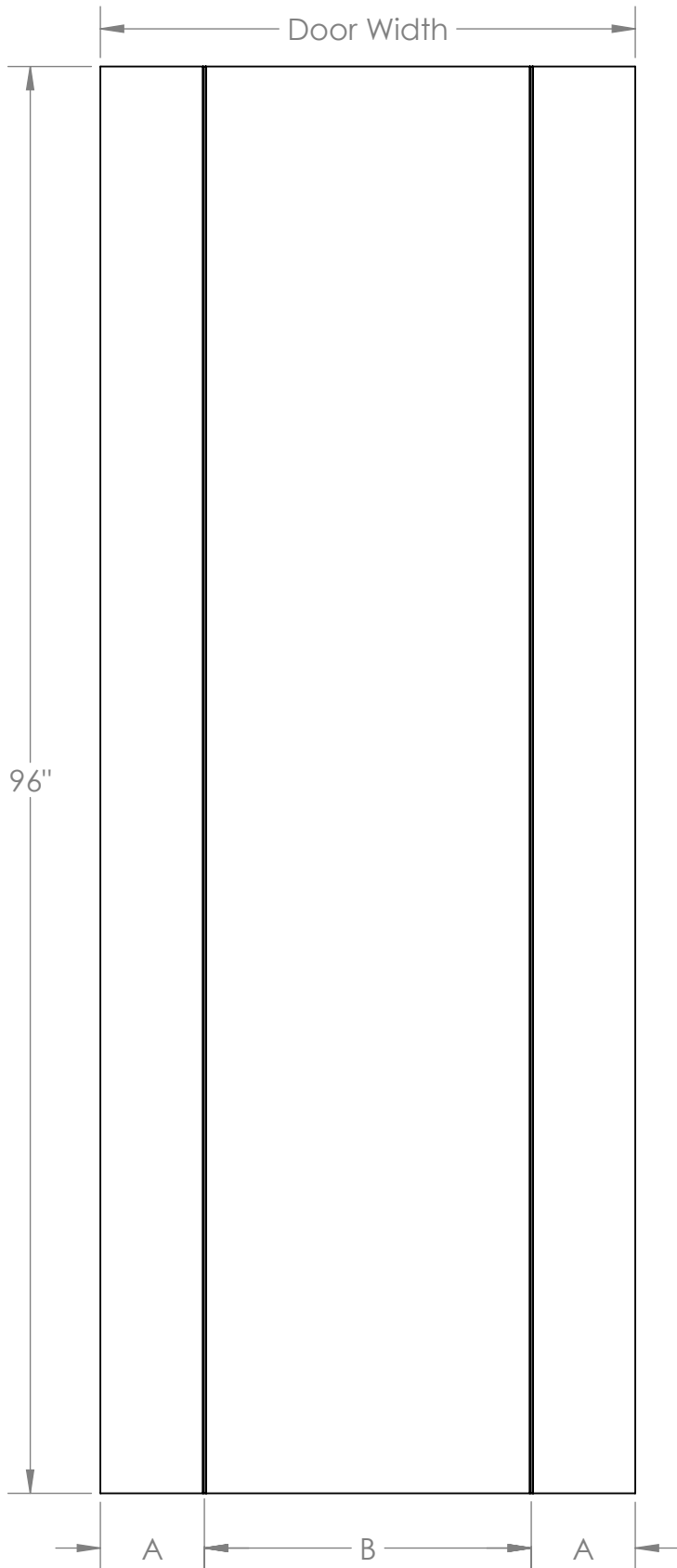

Parkrose 8'0"		
Door Width	A	B
3' 0"	7"	22"
2' 10"	7"	20"
2' 8"	7"	18"
2' 6"	6"	18"
2' 4"	6"	16"
2' 2"	6"	14"
2' 0"	5"	14"
1' 10"	5"	12"
1' 8"	5"	10"
1' 6"	5"	8"

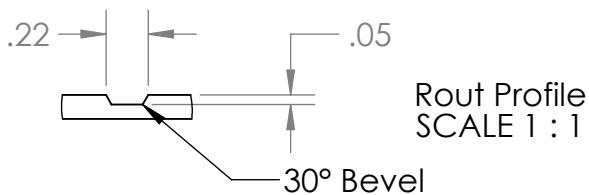

DRAWN	KC	07/28/15	MATERIAL	FINISH Primed
CHECKED	CB	10/26/15	<h2>Lynden Door, Inc.</h2>	
ENG APPR.	-	-		
MFG APPR.	-	-		
Q.A.	-	-		
UNLESS OTHERWISE SPECIFIED: DIMENSIONS ARE IN: Inches TOLERANCES FRACTIONAL: ±1/16 ANGULAR: MACH ±2 BEND ± ONE PLACE DECIMAL: ± TWO PLACE DECIMAL: ±.02 THREE PLACE DECIMAL: ±			<small>THE INFORMATION CONTAINED IN THIS DRAWING IS THE SOLE PROPERTY OF Lynden Door, Inc. ANY REPRODUCTION IN PART OR AS A WHOLE WITHOUT THE WRITTEN PERMISSION OF Lynden Door, Inc. IS PROHIBITED.</small>	
TITLE: Parkrose			SIZE A	REV -
			DWG. NO. A04-00024	WEIGHT:
DO NOT SCALE DRAWING			SCALE: 1:12	SHEET 3 OF 3

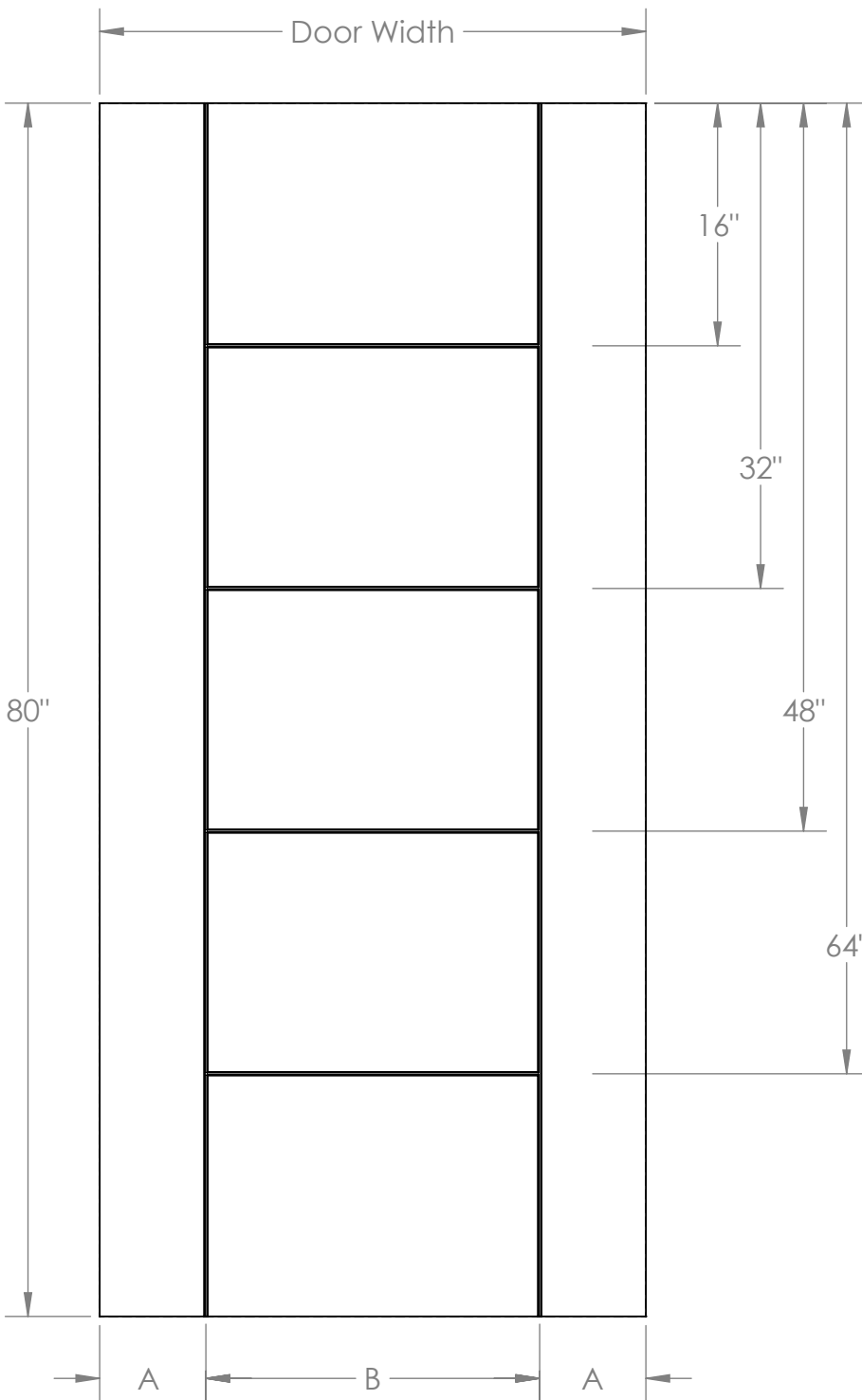

Robson 6'8"		
Door Width	A	B
3' 0"	7"	22"
2' 10"	7"	20"
2' 8"	7"	18"
2' 6"	6"	18"
2' 4"	6"	16"
2' 2"	6"	14"
2' 0"	5"	14"
1' 10"	5"	12"
1' 8"	5"	10"
1' 6"	5"	8"

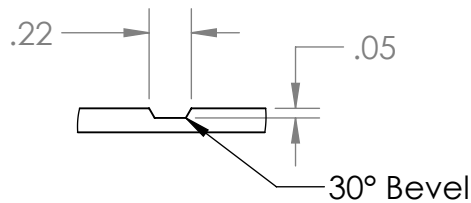

Root Profile
SCALE 1 : 1

Notes:

1. Dimensions are to Centerline of Root Profile
2. Line symmetry tolerance at $\pm 1/32"$

DRAWN	KC	07/28/15	MATERIAL	FINISH Primed	
CHECKED	CB	10/26/15	<h2 style="text-align: center;">Lynden Door, Inc.</h2>		
ENG APPR.	-	-			
MFG APPR.	-	-			
Q.A.	-	-			
<small>UNLESS OTHERWISE SPECIFIED: DIMENSIONS ARE IN: Inches TOLERANCES FRACTIONAL: $\pm 1/16$ ANGULAR: MACH ± 2 BEND ± 1 ONE PLACE DECIMAL: ± 1 TWO PLACE DECIMAL: $\pm .02$ THREE PLACE DECIMAL: $\pm .002$ </small>			<small>THE INFORMATION CONTAINED IN THIS DRAWING IS THE SOLE PROPERTY OF Lynden Door, Inc. ANY REPRODUCTION IN PART OR AS A WHOLE WITHOUT THE WRITTEN PERMISSION OF Lynden Door, Inc. IS PROHIBITED.</small>		
TITLE:			Robson		
SIZE	A	DWG. NO.	A04-00026	REV	-
SCALE:		1:12	WEIGHT:	SHEET 1 OF 3	

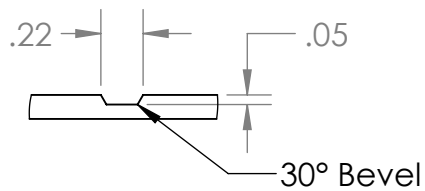
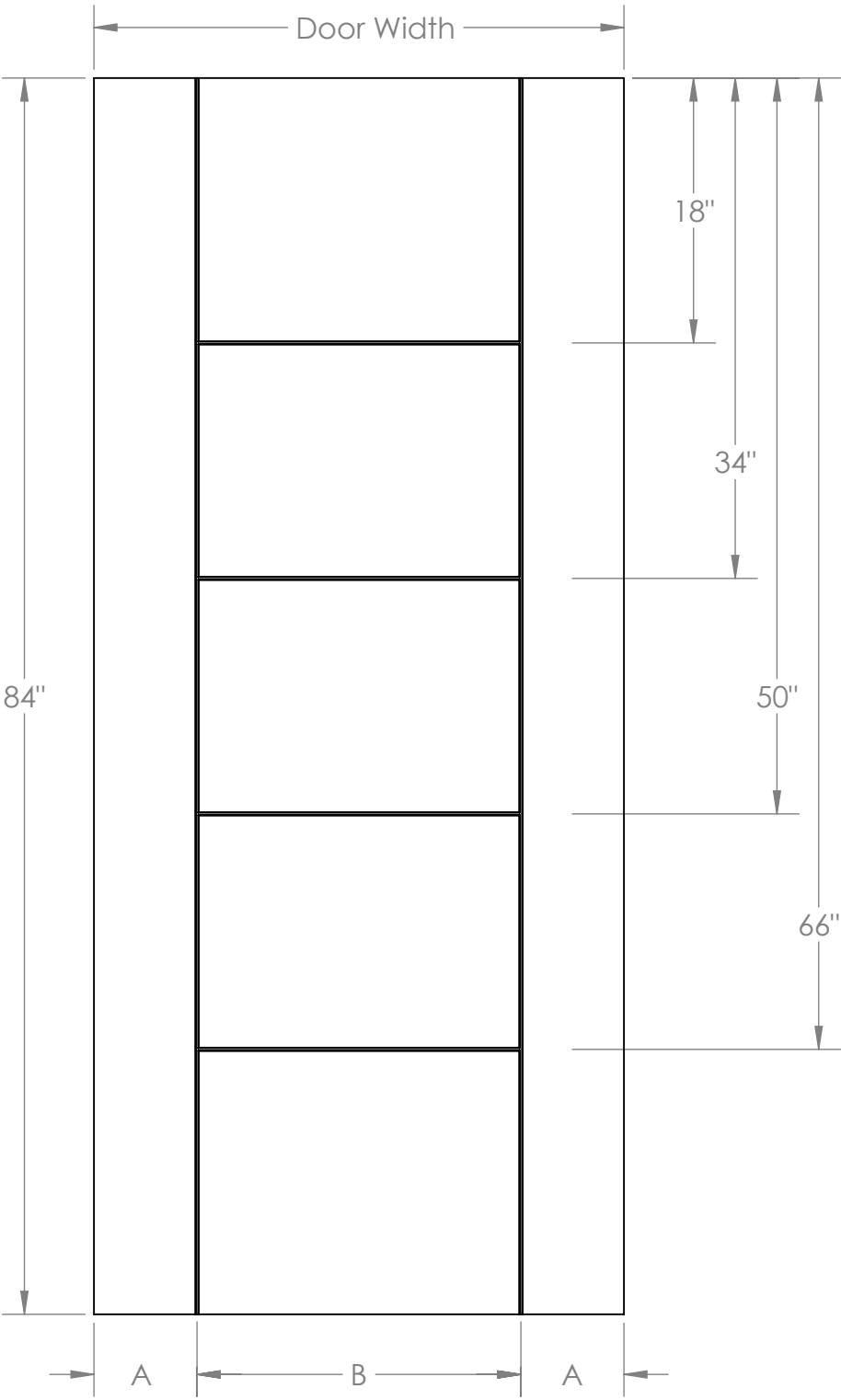

Rout Profile
SCALE 1 : 1

Robson 7'0"		
Door Width	A	B
3' 0"	7"	22"
2' 10"	7"	20"
2' 8"	7"	18"
2' 6"	6"	18"
2' 4"	6"	16"
2' 2"	6"	14"
2' 0"	5"	14"
1' 10"	5"	12"
1' 8"	5"	10"
1' 6"	5"	8"

DRAWN	KC	07/28/15	MATERIAL	FINISH Primed	
CHECKED	CB	10/26/15	<h2>Lynden Door, Inc.</h2>		
ENG APPR.	-	-			
MFG APPR.	-	-			
Q.A.	-	-			
<small>UNLESS OTHERWISE SPECIFIED: DIMENSIONS ARE IN: Inches TOLERANCES FRACTIONAL: ±1/16 ANGULAR: MACH ±2 BEND ± ONE PLACE DECIMAL: ± TWO PLACE DECIMAL: ±.02 THREE PLACE DECIMAL: ±</small>			<small>THE INFORMATION CONTAINED IN THIS DRAWING IS THE SOLE PROPERTY OF Lynden Door, Inc. ANY REPRODUCTION IN PART OR AS A WHOLE WITHOUT THE WRITTEN PERMISSION OF Lynden Door, Inc. IS PROHIBITED.</small>		
TITLE: Robson			SIZE A	DWG. NO. A04-00026	REV -
DO NOT SCALE DRAWING			SCALE: 1:12	WEIGHT:	SHEET 2 OF 3

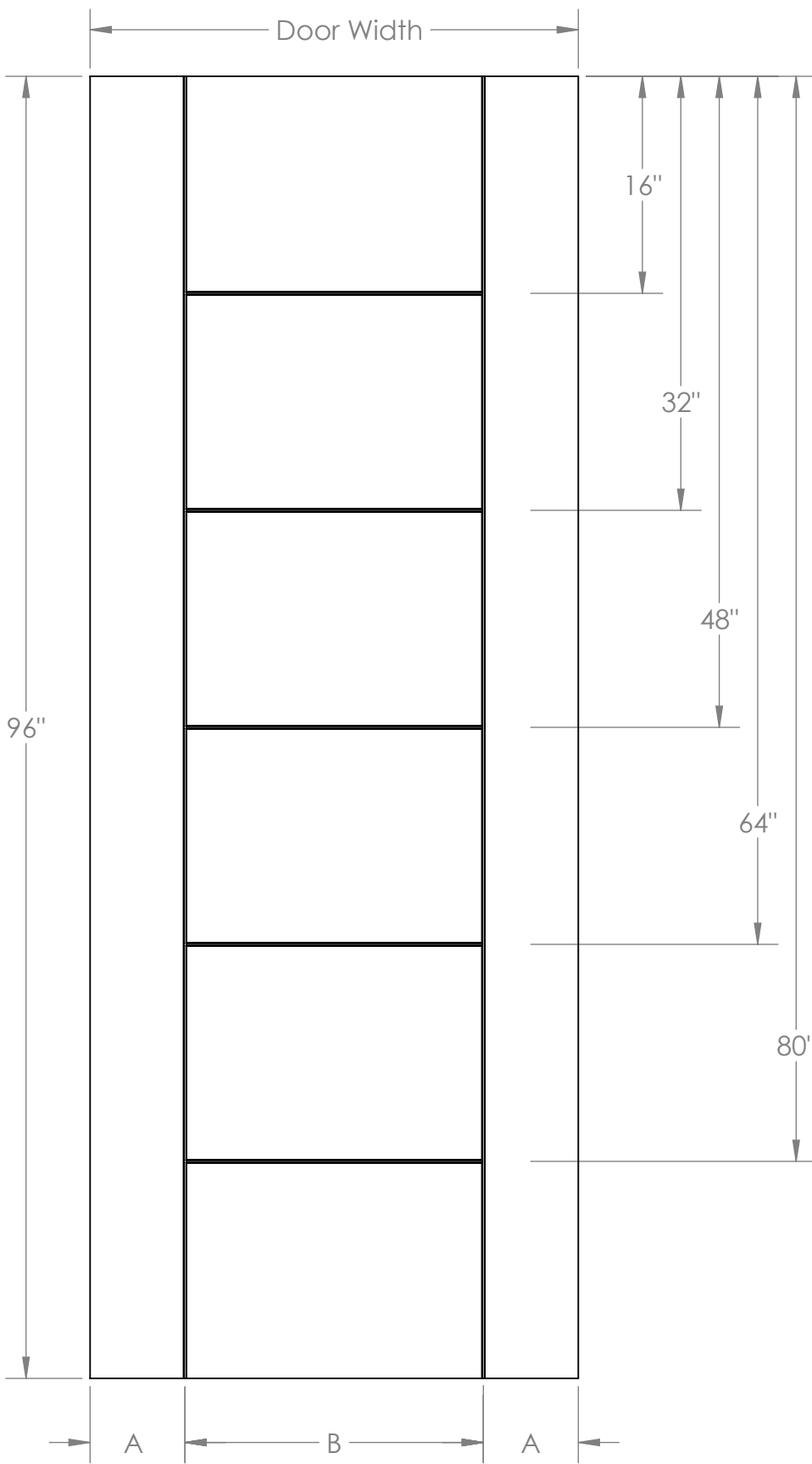

Robson 8'0"		
Door Width	A	B
3' 0"	7"	22"
2' 10"	7"	20"
2' 8"	7"	18"
2' 6"	6"	18"
2' 4"	6"	16"
2' 2"	6"	14"
2' 0"	5"	14"
1' 10"	5"	12"
1' 8"	5"	10"
1' 6"	5"	8"

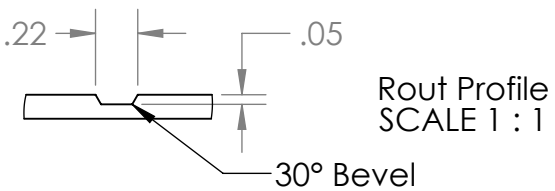

DRAWN	KC	07/28/15	MATERIAL	FINISH Primed	
CHECKED	CB	10/26/15	<h2 style="margin: 0;">Lynden Door, Inc.</h2>		
ENG APPR.	-	-			
MFG APPR.	-	-			
Q.A.	-	-			
<small>UNLESS OTHERWISE SPECIFIED: DIMENSIONS ARE IN: Inches TOLERANCES FRACTIONAL: ±1/16 ANGULAR: MACH ±2 BEND ± ONE PLACE DECIMAL: ± TWO PLACE DECIMAL: ±.02 THREE PLACE DECIMAL: ±</small>			<small>THE INFORMATION CONTAINED IN THIS DRAWING IS THE SOLE PROPERTY OF Lynden Door, Inc. ANY REPRODUCTION IN PART OR AS A WHOLE WITHOUT THE WRITTEN PERMISSION OF Lynden Door, Inc. IS PROHIBITED.</small>		
TITLE: Robson					
SIZE	A	DWG. NO.	A04-00026	REV	-
SCALE: 1:12		WEIGHT:		SHEET 3 OF 3	