

Montlake 6'8"	
Door Width	A
4' 0"	23.75"
3' 6"	20.75"
3' 0"	17.75"
2' 8"	15.75"
2' 6"	14.75"
2' 4"	13.75"
2' 0"	11.75"
1' 6"	8.75"

Notes:

1. Dimensions are to Centerline of Rout Profile
2. Line symmetry tolerance $\pm 1/32"$
3. Groove Depth $\pm .020$

Montlake Bifolds
Fineline



DIMENSIONS ARE IN: Inches
DOOR TOLERANCES
WIDTH (FULL WIDTH): $\pm 1/16$
WIDTH (PREFIT): $\pm 1/32$
HEIGHT: $\pm 1/16$
SQUARE: $\pm 1/8$

THE INFORMATION CONTAINED IN THIS DRAWING IS THE SOLE PROPERTY OF Lynden Door, Inc. ANY REPRODUCTION IN PART OR AS A WHOLE WITHOUT THE WRITTEN PERMISSION OF Lynden Door, Inc. IS PROHIBITED.

A04-00033 01/16/17

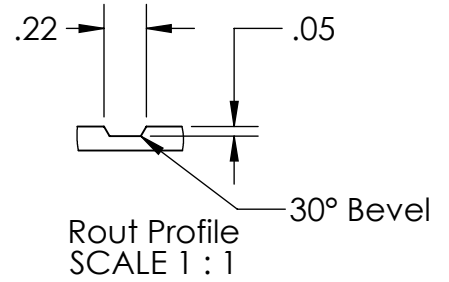
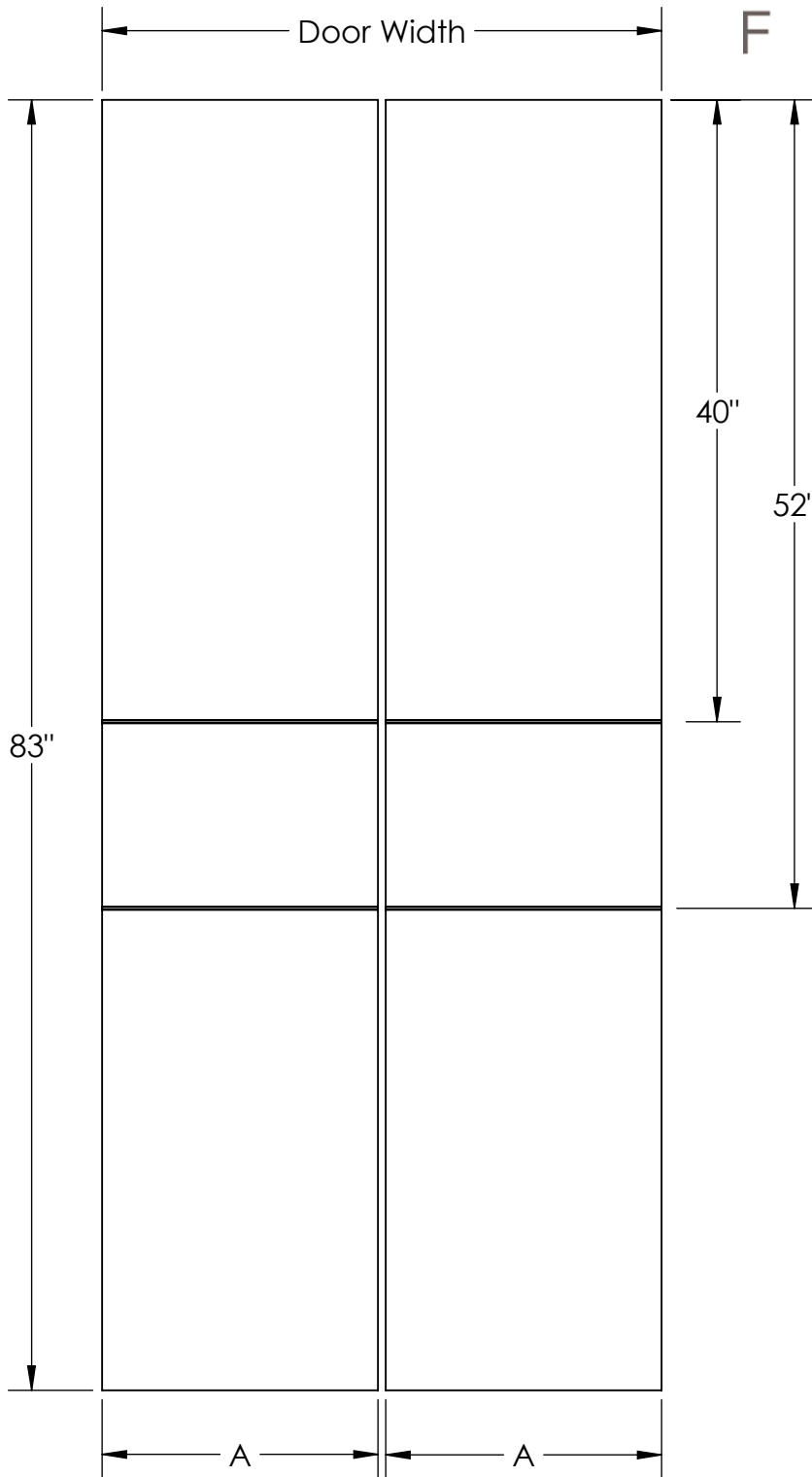

Montlake 7'0"	
Door Width	A
4' 0"	23.75"
3' 6"	20.75"
3' 0"	17.75"
2' 8"	15.75"
2' 6"	14.75"
2' 4"	13.75"
2' 0"	11.75"
1' 6"	8.75"

Notes:

1. Dimensions are to Centerline of Rout Profile
2. Line symmetry tolerance $\pm 1/32"$
3. Groove Depth $\pm .020$

Montlake Bifolds

Fineline



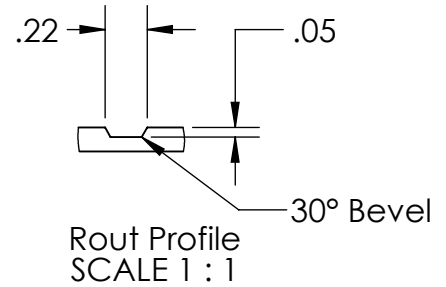
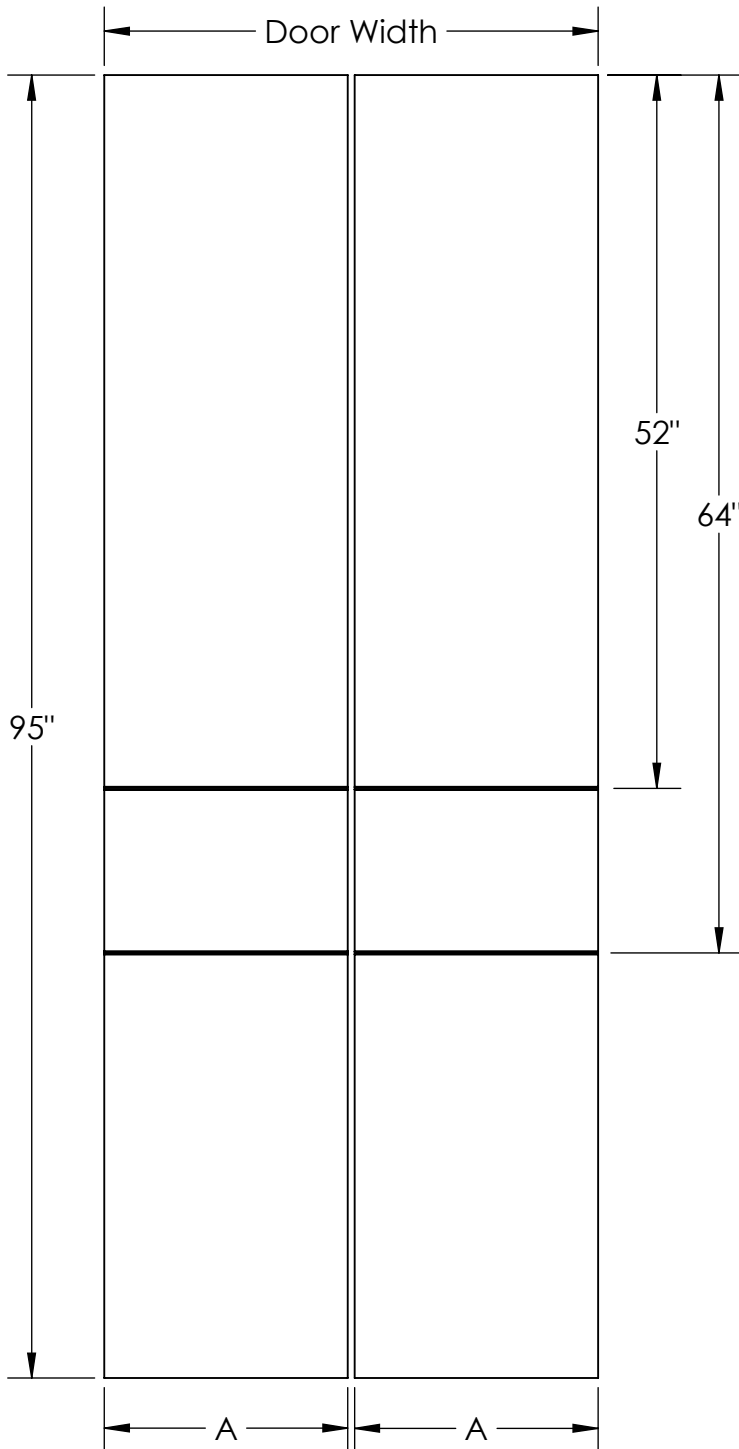

Montlake 8'0"	
Door Width	A
4' 0"	23.75"
3' 6"	20.75"
3' 0"	17.75"
2' 8"	15.75"
2' 6"	14.75"
2' 4"	13.75"
2' 0"	11.75"
1' 6"	8.75"

Notes:

1. Dimensions are to Centerline of Rout Profile
2. Line symmetry tolerance $\pm 1/32$ "
3. Groove Depth $\pm .020$

Montlake Bifolds

Fineline



DIMENSIONS ARE IN: Inches
DOOR TOLERANCES
WIDTH (FULL WIDTH): $\pm 1/16$
WIDTH (PREFIT): $\pm 1/32$
HEIGHT: $\pm 1/16$
SQUARE: $\pm 1/8$

THE INFORMATION CONTAINED IN THIS DRAWING IS THE SOLE PROPERTY OF Lynden Door, Inc. ANY REPRODUCTION IN PART OR AS A WHOLE WITHOUT THE WRITTEN PERMISSION OF Lynden Door, Inc. IS PROHIBITED.

A04-00033 01/16/17